

GENUINE GRACO PARTS AND ACCESSORIES



Merkur[®] Stainless Steel Check Balls Kit

For Merkur LW075A Displacement Pumps

406777B



Important Safety Instructions

Read all warnings and instructions in manuals 312792 and 312794. Save all instructions.

Kit 24A263

Standard Kit: 440 Stainless Steel Balls

Kit 24P613

Optional Kit: 316 Stainless Steel Balls
(Use for high corrosive applications.)

| Ref. | Description | Qty. |
|------|---|------|
| 1 | BALL, piston valve check, stainless steel, 9/16 in. (14 mm) | 1 |
| 2 | BALL, intake valve check, stainless steel, 5/8 in. (16 mm) | 1 |

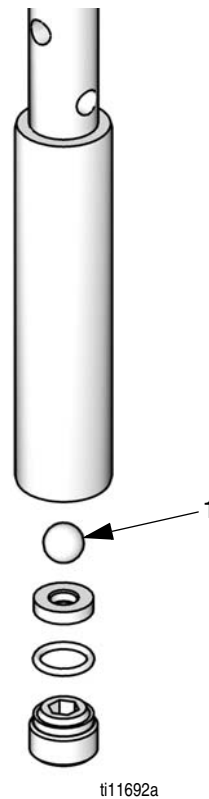

ti11692a

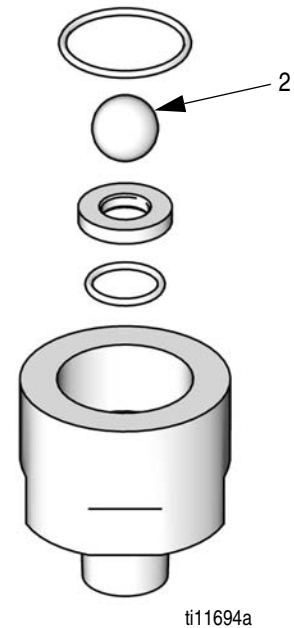

ti11694a

Graco Inc. P.O. Box 1441 Minneapolis, MN 55440-1441

406777 Rev. B - May 2013

Copyright 2008, Graco Inc. is registered to I.S. EN ISO 9001

