

GENUINE GRACO PARTS & ACCESSORIES



238-251 HEAVY-DUTY AGITATOR BEARING REPLACEMENT KIT

For replacing bearings in the heavy-duty, back-geared stainless steel agitator, Model No. 238-157.

INFORMATION ENCLOSED

GRACO INC. / P.O. BOX 1441 / MINNEAPOLIS, MN 55440-1441
406-334 Rev B July 2019 PRINTED IN U.S.A.

	! WARNING	
For detailed instructions and warnings, see manual 308-609.		

Ref No.	Part No.	Description	Qty.
2	191-004	BEARING, needle; 3/4"	2
4	100-069	BALL, thrust	2
7	113-363	SEAL, bearing; 45 mm	1
9	190-980	BEARING, needle; 45 mm	1
12	190-978	BEARING, needle; 50 mm	1
14	113-359	SEAL, bearing; 50 mm	1
15	190-979	BEARING, needle, thrust; 50 mm	1

NOTE: See the back side of this page for installation instructions. Before you begin, perform all of the "Disassembling" and "Cleaning and Servicing" steps in the **Servicing the Gear Reducer** section of manual 308-609. For your starting point, have the unit disassembled and cleaned and the upper housing upside down on the workbench.

- 1** Orient the seals (7 and 14) so the open, *cupped* side of the soft sealing surface is facing up.
- 2** Make sure you remove the old thrust balls (4) when you remove the needle bearings (2).

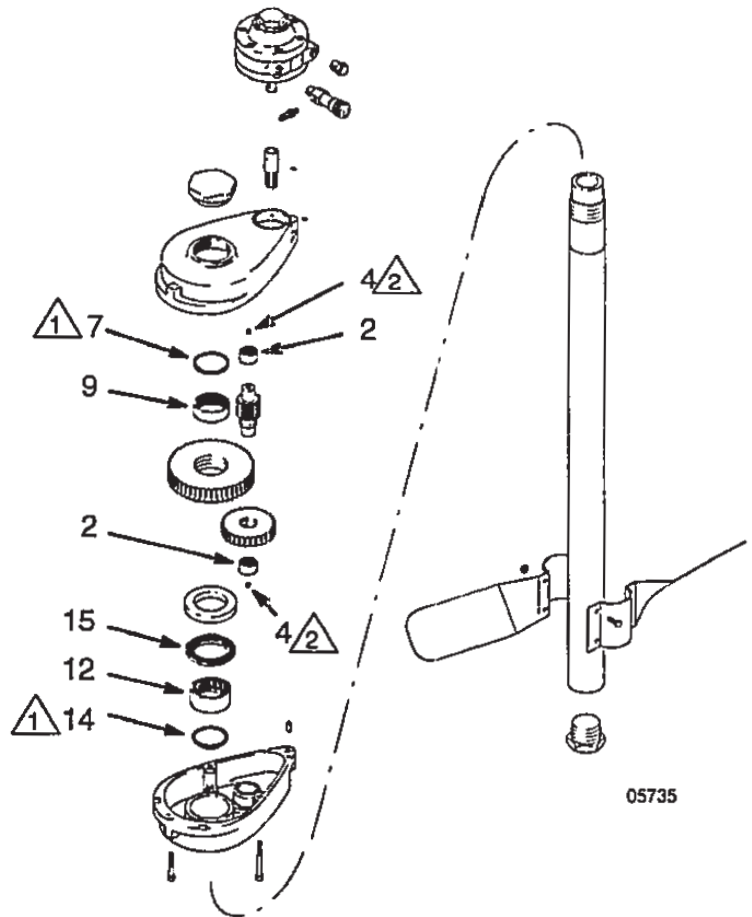

05735

1. Remove the needle bearing (2) from the upper housing with an inside bearing puller, and remove the thrust ball (4).
2. Turn the upper housing so the printed "Graco" is up, and press the bearing seal (7) and needle bearing (9) out of the housing.
NOTE: For a pressing tool, use a socket with an outside diameter slightly smaller than the inside diameter of the boss.
3. Clean the upper housing thoroughly.
4. Place the upper housing on the workbench so the inside of the housing is facing up. Using a flat plate, press the new bearing seal (7), with the open, *cupped* side of the soft sealing surface facing down. Press until the bearing seal is flush with the inside surface of the housing.
5. Place the new needle bearing (9), with the printed side **UP**, on top of the bearing seal (7). Using a flat plate, press the needle bearing until it is flush with the inside surface of the housing.
6. Place the new needle bearing (2), with the printed side **up**, in the housing. Using a flat plate, press it until it is flush with the inside surface of the housing.
7. Place the new thrust ball (4) in the recessed area of the center of the bearing (2). Hold it in place with grease.
8. Cover the upper housing to keep foreign material out of the new bearings, and set the housing aside.
9. Set the lower housing on the workbench with the inside of the housing facing up, and remove the needle bearing (2) from the lower housing with an inside bearing puller. Remove the thrust ball (4).
10. Turn the lower housing over so the printed "Graco" is up, and press the bearing seal (14), needle bearing (12), and needle bearing (15) out of the housing. Because of limited clearance in the housing, you must press out one part at a time.
NOTE: For a pressing tool, use a socket with an outside diameter slightly smaller than the inside diameter of the boss.
11. Clean the lower housing thoroughly.
12. Place the lower housing on the workbench so the inside of the housing is facing up. Using a flat plate, press the new bearing seal (14), with the open, *cupped* side facing up, into the housing.
NOTE: Bearing seal (14) must be pressed in from the inside of the housing to avoid damaging the seal.
13. Place the new needle bearing (12), with the printed side **DOWN**, on top of the bearing seal (14). Using a socket with an outside diameter slightly smaller than the inside diameter of the boss, press the needle bearing only until the bearing seal reaches the bottom of the boss. **Do not compress the seal.**
14. Lift the race out of the raceway of the thrust bearing (15), place the thrust bearing, raceway side up, on the lower housing, center a socket (with an outside diameter larger than the inside diameter of the raceway) on the raceway, press the thrust bearing into place, and replace the race.
15. Place the new needle bearing (2), with the printed side **UP**, in the housing. Using a flat plate, press the needle bearing until it is flush with the inside surface of the housing.
16. Place the new thrust ball (4) into the recessed area in the center of the bearing (2). Hold it in place with grease.
17. See "Reassembly" in the **Servicing the Gear Reducer** section of manual 308-609.