

# DataTrak<sup>®</sup> Kits

3A4385B

EN

*For providing cycle count and material usage information for E-10 sprayers. For professional use only.*

## **Accessory Kit 25M269 and 25P193**



### **Important Safety Instructions**

Read all warnings and instructions in this manual and in the spray package manual. Save all instructions.

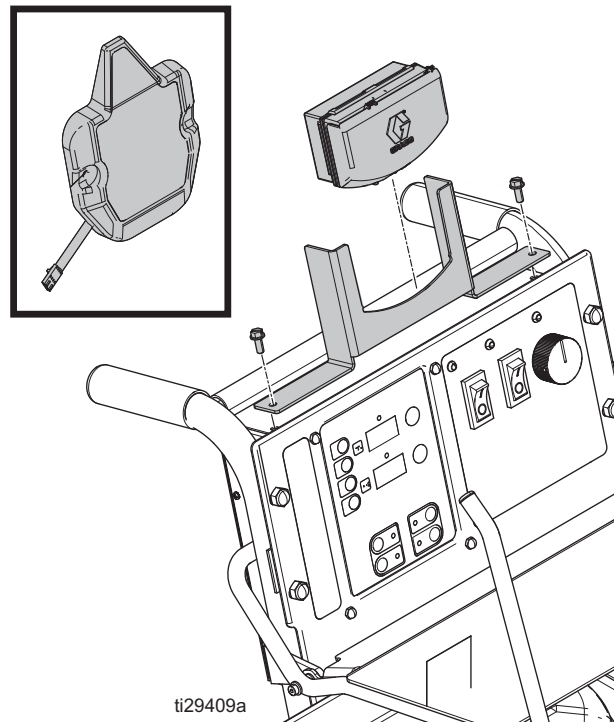

# Contents

**Contents** ..... 2

**Related Manuals** ..... 2

**Warnings** ..... 3

**Installation** ..... 4

    Prepare to Install ..... 4

    Install the Kit ..... 4

    Check DataTrak Operation ..... 5

**DataTrak Controls and Indicators** ..... 6

**DataTrak Operation** ..... 7

    Setup Mode ..... 7

    Run Mode ..... 7

**DataTrak Diagnostic Codes** ..... 8

**Repair** ..... 9

    Replace Battery ..... 9

    Replace Fuse ..... 9

**Parts** ..... 10

**California Proposition 65** ..... 11

**Graco Standard Warranty** ..... 12



**Graco Information** ..... 12

# Related Manuals

Manual in English	Description
311075	E-10 Manual
332144	E-10hp Manual

# Warnings

The following warnings are for the setup, use, grounding, maintenance, and repair of this equipment. The exclamation point symbol alerts you to a general warning and the hazard symbols refer to procedure-specific risks. When these symbols appear in the body of this manual or on warning labels, refer back to these Warnings. Product-specific hazard symbols and warnings not covered in this section may appear throughout the body of this manual where applicable.

 <h2 style="margin: 0;">WARNING</h2>	
	<p><b>MOVING PARTS HAZARD</b></p> <p>Moving parts can pinch, cut or amputate fingers and other body parts.</p> <ul style="list-style-type: none"> <li>• Keep clear of moving parts.</li> <li>• Do not operate equipment with protective guards or covers removed.</li> <li>• Pressurized equipment can start without warning. Before checking, moving, or servicing equipment, follow the <b>Pressure Relief Procedure</b> and disconnect all power sources.</li> </ul>
	<p><b>EQUIPMENT MISUSE HAZARD</b></p> <p>Misuse can cause death or serious injury.</p> <ul style="list-style-type: none"> <li>• Do not operate the unit when fatigued or under the influence of drugs or alcohol.</li> <li>• Do not exceed the maximum working pressure or temperature rating of the lowest rated system component. See <b>Technical Data</b> in all equipment manuals.</li> <li>• Use fluids and solvents that are compatible with equipment wetted parts. See <b>Technical Data</b> in all equipment manuals. Read fluid and solvent manufacturer's warnings. For complete information about your material, request Safety Data Sheet (SDS) from distributor or retailer.</li> <li>• Do not leave the work area while equipment is energized or under pressure.</li> <li>• Turn off all equipment and follow the <b>Pressure Relief Procedure</b> when equipment is not in use.</li> <li>• Check equipment daily. Repair or replace worn or damaged parts immediately with genuine manufacturer's replacement parts only.</li> <li>• Do not alter or modify equipment. Alterations or modifications may void agency approvals and create safety hazards.</li> <li>• Make sure all equipment is rated and approved for the environment in which you are using it.</li> <li>• Use equipment only for its intended purpose. Call your distributor for information.</li> <li>• Route hoses and cables away from traffic areas, sharp edges, moving parts, and hot surfaces.</li> <li>• Do not kink or over bend hoses or use hoses to pull equipment.</li> <li>• Keep children and animals away from work area.</li> <li>• Comply with all applicable safety regulations.</li> </ul>

# Installation

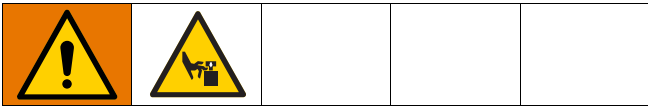

## Prepare to Install

1. See E-10 or E-10hp manual and follow the instructions in the Before Beginning Repair section, including the Pressure Relief Procedure.
2. Disconnect all line power to the sprayer.

## Install the Kit

1. Remove the two top fasteners (F) on the control panel cover. Leave bottom fasteners and cover assembled.

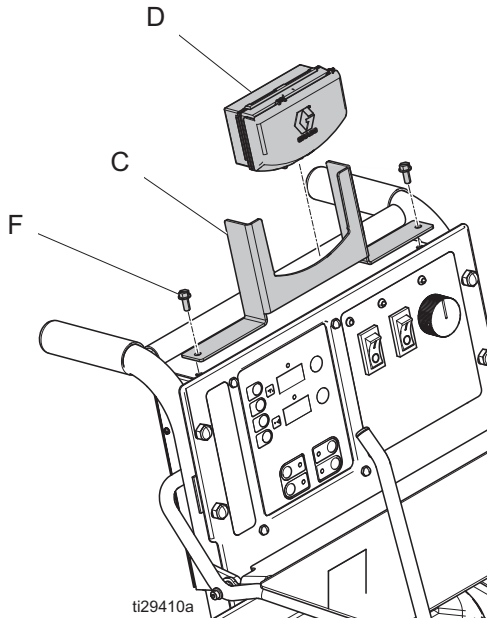

FIG. 1

2. Align the holes of the mounting bracket (C) with the cover and reinstall top fasteners.
3. Remove the two fasteners and ISO side drive housing cover.

4. With cover removed, place magnet (A) on the crank shaft.

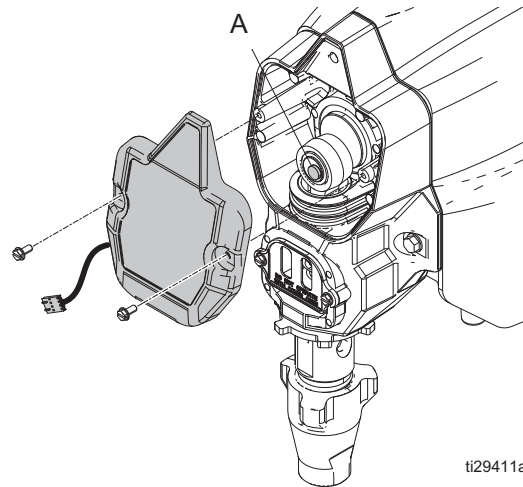

FIG. 2

**NOTE:** The magnet placement on the crank is crucial to proper DataTrak operation. Offset the magnet to the far side to get the largest diameter possible.

5. Install cover/reed switch assembly (B), ensure both cables are routed through the notch (N).

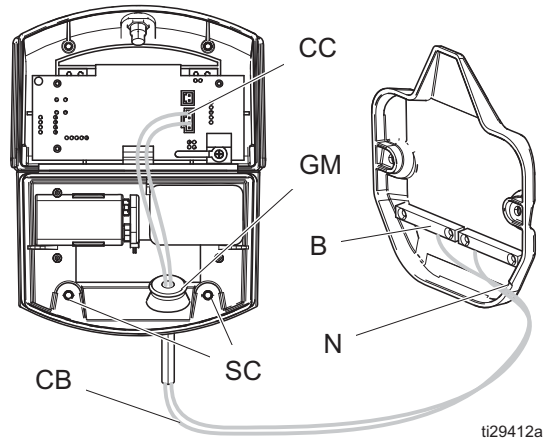

FIG. 3

6. Route cable (CB) through the frame up to the control panel of the E-10.
7. Remove two screws (SC) on back of the DataTrak (D).
8. Insert cable (CB) through module and install grommet (GM).
9. Connect cable connector (CC).

10. Reassemble module and slide DataTrak (D) into the mounting bracket (C).

## Check DataTrak Operation

1. Cycle the sprayer in slow recirculation mode.

**NOTE:** The DataTrak pump icon should move when the pump rotates.

**NOTE:** The grand totalizer and the batch totalizer should advance.

2. Cycle the sprayer in fast recirculation mode for at least 10 cycles to ensure no errors.

**NOTE:** If there is an error, adjust the magnet placement on the crankshaft to ensure both reed switches pick up the signal. See FIG. 4.

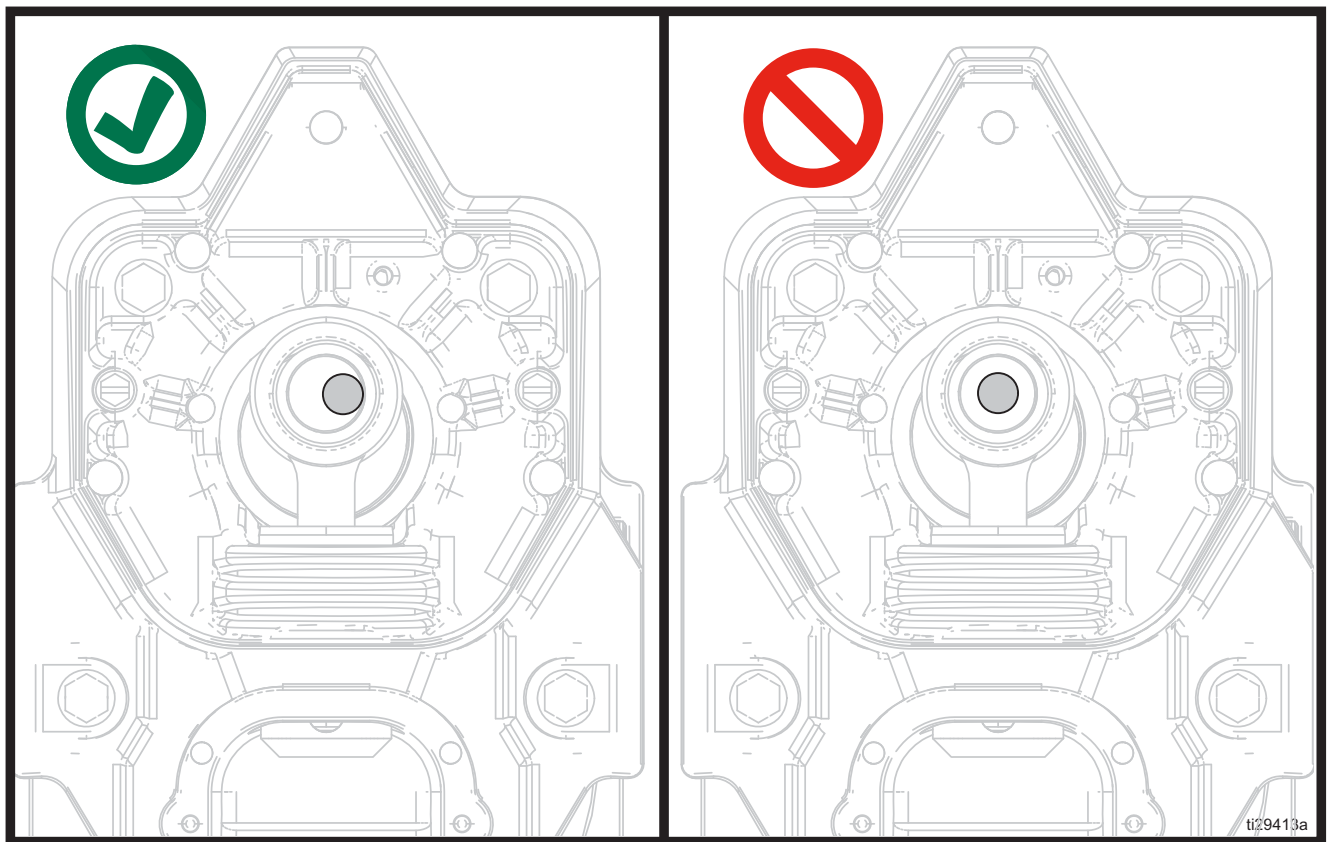

Keep the magnet offset to the side of the crankshaft surface to create the largest range of motion.

Do not place the magnet in the center of the crankshaft. This creates a smaller range of motion.

FIG. 4

# DataTrak Controls and Indicators

AB	E-10 Type (user settable)	RK	Reset Key (Resets faults. Press and hold for 3 seconds to clear the batch totalizer.) Push to toggle between flow rate and cycle rate.
AC	Flow Rate Units (user settable to gpm [US], gpm [Imperial], oz/min [US], oz/min [Imperial], l/min, or cc/min)	CF	Cycle/Flow Rate
AD	LED (fault indicator when lit)	BT	Batch Totalizer
AE	Display	GT	Grand Totalizer
PF	Prime/Flush Key (enables Prime/Flush mode. While in Prime/Flush mode, the batch totalizer [BT] will not count.) LED will flash while in Prime/Flush mode.		

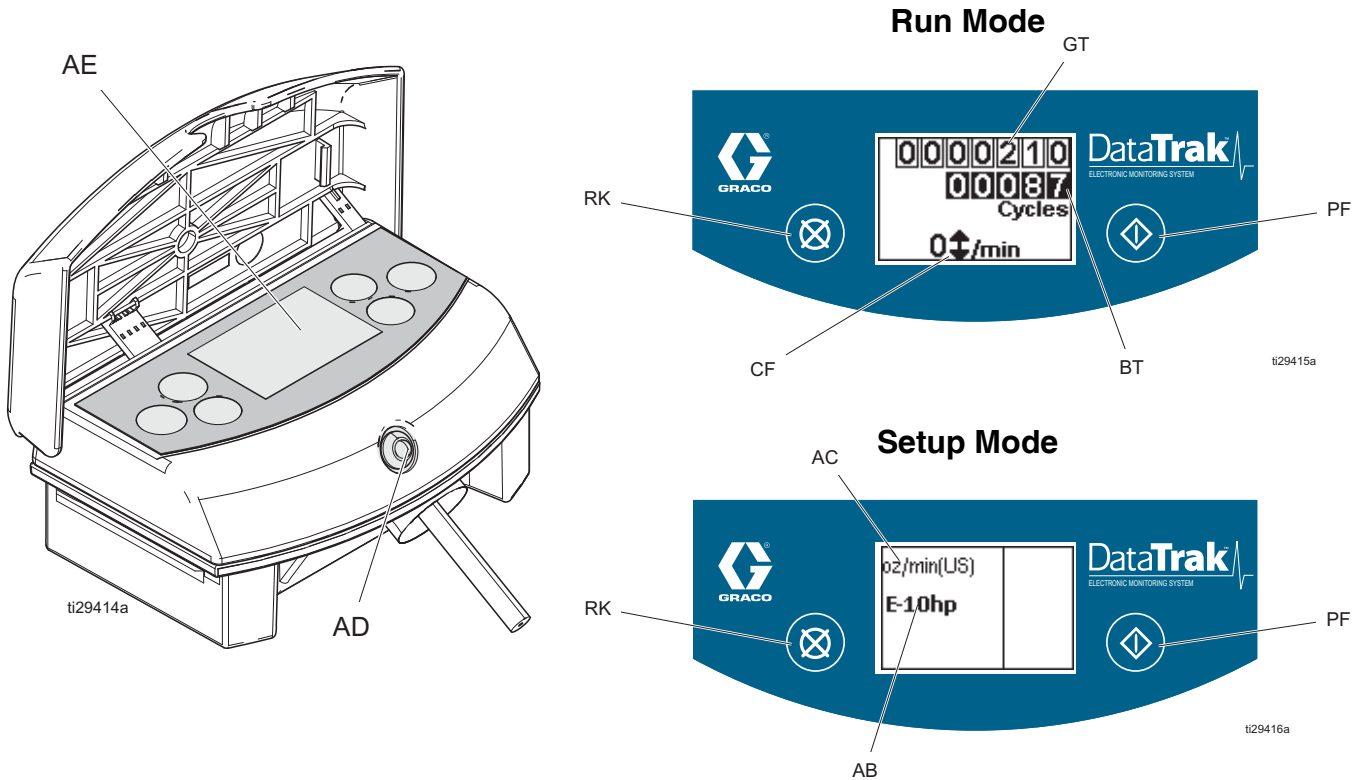

FIG. 5





# DataTrak Operation

The display (AE) will turn off after 1 minute to save battery life. Press any key to wake up the display.

## NOTICE

To prevent damage to the soft key buttons, do not press the buttons with sharp objects such as pens, plastic cards, or fingernails.

## Setup Mode

1. See FIG. 5, page 6. Press and hold  for 5 seconds until Setup menu appears.
2. To enter settings for system type and flow rate units, press  to change the value, then  to save the value and move the cursor to the next data field.
  - Set system type (AC).
3. Move the cursor to the system type field (AC), then press  once more to exit Setup mode.

## Run Mode

### Prime/Flush

1. See FIG. 5, page 6. To enter Prime/Flush mode, press any key to wake up the display, then press . The Prime indicator will appear in the display and the LED will flash.

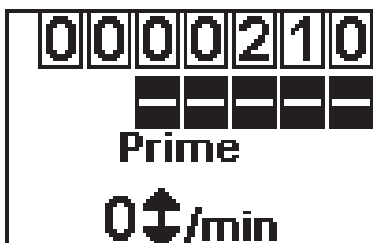





FIG. 6

2. While in Prime/Flush mode, the batch totalizer (BT) will not count. The grand totalizer (GT) continues to count.
3. To exit Prime/Flush mode, press any key to wake up the display, then press . The Prime/Flush symbol will disappear from the display and the LED will stop flashing.

### Counter/Totalizer

1. See FIG. 5, page 6. The last digit of the batch totalizer (BT) represents the tenths of gallons or liters. To reset the totalizer, press any key to wake up the display, then press and hold  for 3 seconds.
  - If AC is set to ounces, BT and GT display ounces
  - If AC is set to gallons, BT and GT display gallons
  - If AC is set to liters or cc, BT and GT display liters.
  - If AC is set to cycles, BT and GT display cycles.
2. Press  to toggle between flow rate units and cycles. A letter under the BT display indicates that both BT and GT are displaying gallons (g), liters (l), or ounces (oz). The word 'cycles' means both BT and GT are displaying cycles.

### Display

See FIG. 5, page 6. The display (AE) will turn off after 1 minute of inactivity in Run mode or 3 minutes in Setup mode. Press any key to wake up the display.

DataTrak will continue to count cycles when the display is off.

The display (AE) may turn off if a high-level static discharge is applied to the DataTrak, Press any key to wake up the display.



### Diagnostics

See DataTrak Diagnostic Codes, page 8.

# DataTrak Diagnostic Codes

When the monitor detects a problem, the LED will flash and a diagnostic code will appear on the display.

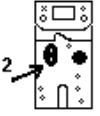
To acknowledge the diagnosis and return to normal operating screen, press  once to wake up the display, and once more to clear the diagnostic code screen.

Symbol	Code	Code Name	Diagnosis	Cause
 <b>E5</b>	E-5	Reed Switch error	Module not reading Reed Switch pulses	<ul style="list-style-type: none"> <li>• Improper magnet placement</li> <li>• Faulty Reed Switch</li> </ul>
 <b>E6</b> Fuse 63 mA	E-6	Blown fuse	Fuse is blown. Replace fuse; see Reactor A-25 Repair manual	<ul style="list-style-type: none"> <li>• Faulty solenoid or solenoid wiring</li> <li>• Extreme temperatures (above 140°F [60°C])</li> </ul>

# Repair

**NOTE:** Use only the following approved replacement batteries. Use of an unapproved battery will void Graco's warranty.

- Ultralife lithium #U9VL
- Duracell alkaline #MN1604
- Energizer alkaline #522
- Varta alkaline #4922

**NOTE:** Use only a Graco-approved replacement fuse. Order Part 24V216.

## Replace Battery

1. Remove DataTrak module (D) from bracket. See FIG. 7.

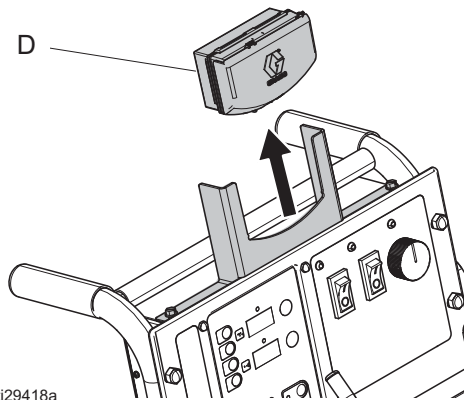
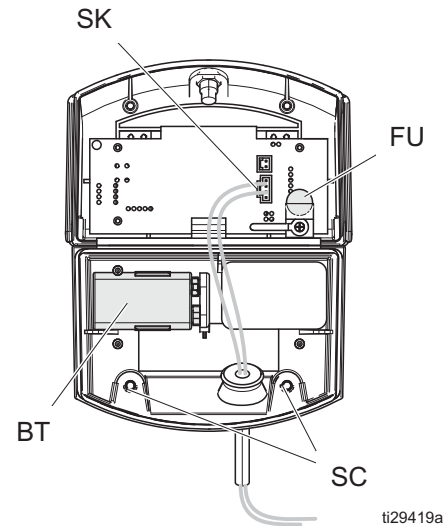

**FIG. 7. Remove DataTrak**

2. Remove two screws (SC in FIG. 8) on back of module to access battery.
3. Disconnect the used battery and replace with an approved battery.

## Replace Fuse

1. Remove the screw, metal strap, and plastic holder.
2. Pull the fuse (FU) away from the board.
3. Replace with a new fuse.



**FIG. 8. DataTrak Battery and Fuse Location**

# Parts

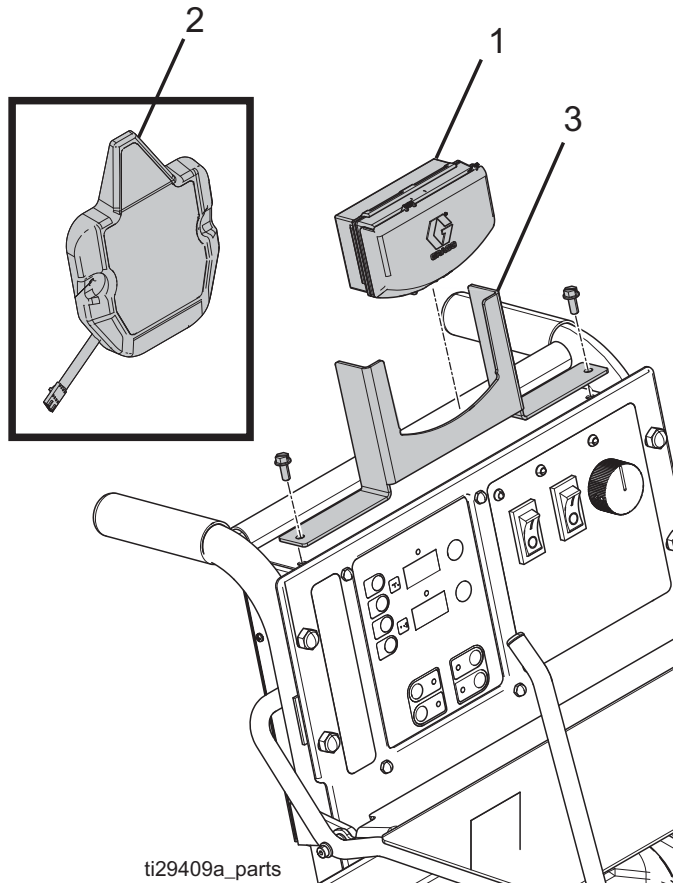

Ref.	Part	Description	Qty.
1		MODULE, DataTrak, cycle counter	1
2		KIT, cover, cycle counter, E-10	1
3		BRACKET, wall mount, DataTrak	1
4	119875	MAGNET, disc, 0.38 diameter, 0.100 thick	1

# California Proposition 65

## CALIFORNIA RESIDENTS

 **WARNING:** Cancer and reproductive harm – [www.P65warnings.ca.gov](http://www.P65warnings.ca.gov).

# Graco Standard Warranty

Graco warrants all equipment referenced in this document which is manufactured by Graco and bearing its name to be free from defects in material and workmanship on the date of sale to the original purchaser for use. With the exception of any special, extended, or limited warranty published by Graco, Graco will, for a period of twelve months from the date of sale, repair or replace any part of the equipment determined by Graco to be defective. This warranty applies only when the equipment is installed, operated and maintained in accordance with Graco's written recommendations.

This warranty does not cover, and Graco shall not be liable for general wear and tear, or any malfunction, damage or wear caused by faulty installation, misapplication, abrasion, corrosion, inadequate or improper maintenance, negligence, accident, tampering, or substitution of non-Graco component parts. Nor shall Graco be liable for malfunction, damage or wear caused by the incompatibility of Graco equipment with structures, accessories, equipment or materials not supplied by Graco, or the improper design, manufacture, installation, operation or maintenance of structures, accessories, equipment or materials not supplied by Graco.

This warranty is conditioned upon the prepaid return of the equipment claimed to be defective to an authorized Graco distributor for verification of the claimed defect. If the claimed defect is verified, Graco will repair or replace free of charge any defective parts. The equipment will be returned to the original purchaser transportation prepaid. If inspection of the equipment does not disclose any defect in material or workmanship, repairs will be made at a reasonable charge, which charges may include the costs of parts, labor, and transportation.

**THIS WARRANTY IS EXCLUSIVE, AND IS IN LIEU OF ANY OTHER WARRANTIES, EXPRESS OR IMPLIED, INCLUDING BUT NOT LIMITED TO WARRANTY OF MERCHANTABILITY OR WARRANTY OF FITNESS FOR A PARTICULAR PURPOSE.**

Graco's sole obligation and buyer's sole remedy for any breach of warranty shall be as set forth above. The buyer agrees that no other remedy (including, but not limited to, incidental or consequential damages for lost profits, lost sales, injury to person or property, or any other incidental or consequential loss) shall be available. Any action for breach of warranty must be brought within two (2) years of the date of sale.

**GRACO MAKES NO WARRANTY, AND DISCLAIMS ALL IMPLIED WARRANTIES OF MERCHANTABILITY AND FITNESS FOR A PARTICULAR PURPOSE, IN CONNECTION WITH ACCESSORIES, EQUIPMENT, MATERIALS OR COMPONENTS SOLD BUT NOT MANUFACTURED BY GRACO.** These items sold, but not manufactured by Graco (such as electric motors, switches, hose, etc.), are subject to the warranty, if any, of their manufacturer. Graco will provide purchaser with reasonable assistance in making any claim for breach of these warranties.

In no event will Graco be liable for indirect, incidental, special or consequential damages resulting from Graco supplying equipment hereunder, or the furnishing, performance, or use of any products or other goods sold hereto, whether due to a breach of contract, breach of warranty, the negligence of Graco, or otherwise.

## **FOR GRACO CANADA CUSTOMERS**

The Parties acknowledge that they have required that the present document, as well as all documents, notices and legal proceedings entered into, given or instituted pursuant hereto or relating directly or indirectly hereto, be drawn up in English. Les parties reconnaissent avoir convenu que la rédaction du présente document sera en Anglais, ainsi que tous documents, avis et procédures judiciaires exécutés, donnés ou intentés, à la suite de ou en rapport, directement ou indirectement, avec les procédures concernées.

## Graco Information

For the latest information about Graco products, visit [www.graco.com](http://www.graco.com).

For patent information, see [www.graco.com/patents](http://www.graco.com/patents).

**TO PLACE AN ORDER**, contact your Graco distributor or call to identify the nearest distributor.

**Phone:** 612-623-6921 **or Toll Free:** 1-800-328-0211 **Fax:** 612-378-3505

*All written and visual data contained in this document reflects the latest product information available at the time of publication. Graco reserves the right to make changes at any time without notice.*

Original instructions. This manual contains English. MM 3A4385

**Graco Headquarters:** Minneapolis

**International Offices:** Belgium, China, Japan, Korea

**GRACO INC. AND SUBSIDIARIES • P.O. BOX 1441 • MINNEAPOLIS MN 55440-1441 • USA**  
**Copyright 2020, Graco Inc. All Graco manufacturing locations are registered to ISO 9001.**

[www.graco.com](http://www.graco.com)

Revision B, May 2020