

Belt Repair Kit 257818

313887A

- For servicing FinishPro 290 Sprayers -



Important Safety Instructions

For detailed instructions and warnings, see sprayer manual.

Pressure Relief Procedure

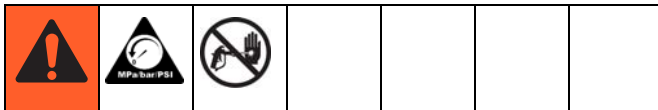

To reduce the risk of injury from injection, always follow this procedure when instructed to relieve pressure, stop spraying, service equipment, or install or clean spray tip.

1. Set power/function selection switch to OFF and unplug sprayer.
2. Turn pressure knob to lowest setting.
3. Hold gun to side of grounded metal pail. Trigger the gun to relieve pressure.
4. Turn prime valve to PRIME.

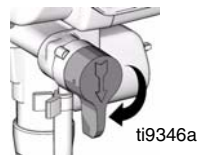

*If you suspect spray tip or hose is completely clogged, or that pressure has not been fully relieved after following these steps, **VERY SLOWLY** loosen tip guard retaining nut or hose end coupling to relieve pressure gradually, then loosen completely. Clear tip or hose obstruction.*

Compressor Belt Removal

1. Relieve Pressure (see cover).
2. Remove three screws and belt cover.

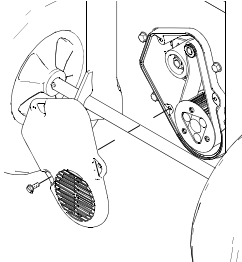

ti13413a

3. Remove three screws and belt guide plate.

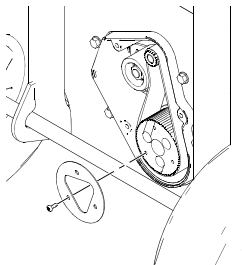

ti13407a

4. Loosen top and bottom idler pulley bracket screws.

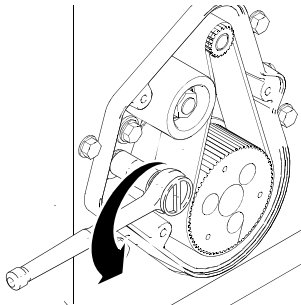

ti13408a

5. Pull idler back and remove belt from pulleys.

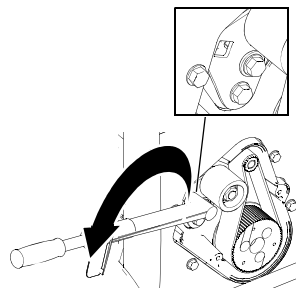

ti13412a

Compressor Belt Installation

1. Install belt and guide plate with three screws.

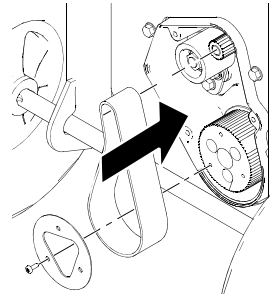

ti13443a

2. Place torque wrench in square hole and torque to 60 in-lb to properly tension belt. Tighten top and bottom idler screws.

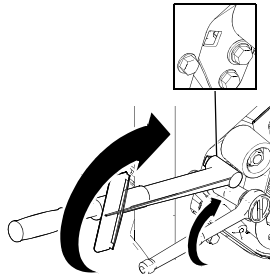

ti13417a

3. Torque top and bottom idler screws to 120 in-lb.

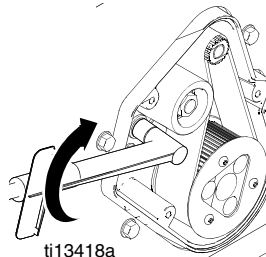

ti13418a

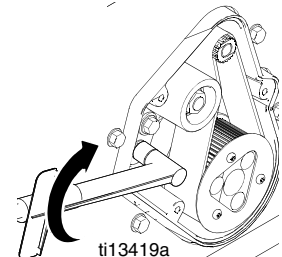

ti13419a

4. Install belt cover with three screws.

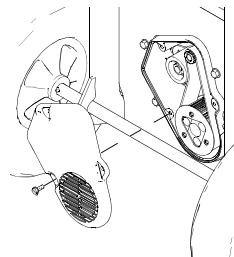

ti13413a

All written and visual data contained in this document reflects the latest product information available at the time of publication. Graco reserves the right to make changes at any time without notice.

This manual contains English. MM 313887

Graco Headquarters: Minneapolis
International Offices: Belgium, China, Japan, Korea

GRACO INC. P.O. BOX 1441 MINNEAPOLIS, MN 55440-1441
 Copyright 2009, Graco Inc. is registered to ISO 9001
www.graco.com