

FP295 Control Board Replacement Kit

313761B

EN

Fluid Pump Control Board Replacement Kit: 257802 (120V Models), 257837 (240V Models)
Compressor Control Board Replacement Kit: 257819 (120V Models), 257820 (240V Models)



IMPORTANT SAFETY INSTRUCTIONS

Read all warnings and safety instructions in sprayer manual.
Be familiar with the controls and the proper usage of the equipment.
Save these instructions.



To reduce the risk of fluid injection or splashing in the eyes or on the skin, relieve all fluid pressure in system before you install, remove, or replace any parts. See the **Pressure Relief Procedure** provided in your Operation manual.

Fluid Pump Control Board Replacement

Disassembly

1. Unplug electrical cord and **Relieve Pressure**.
2. Remove enclosure mounting screws (A). Pull enclosure (B) away from drive housing (C). Take care to not pull on the leads from the electrical cord and the power switch.
3. Disconnect motor harness (D), electrical cord and power switch lead from control board (E). (Also see wiring diagram for your sprayer model.)
4. Remove screw (F) that mounts control board (E) and pull control board approximately 2 in. (50 mm) back from drive housing (C).
5. Disconnect pressure control wiring harness from connector (G) on front of control board (E). Use fingernail or flat blade screwdriver to press tab on right side of connector to release.

Installation

Installation

1. Connect pressure control wiring harness to new control board connector (G).
2. Install new control board (E) on drive housing (C) and tighten control board mounting screw (F).
3. Connect power switch, electrical cord leads and motor harness (D) to control board (E). (Also see wiring diagram for your sprayer model.)
4. Replace enclosure (B) and tighten enclosure mounting screws (A). When reassembling enclosure, take care not to pinch leads.

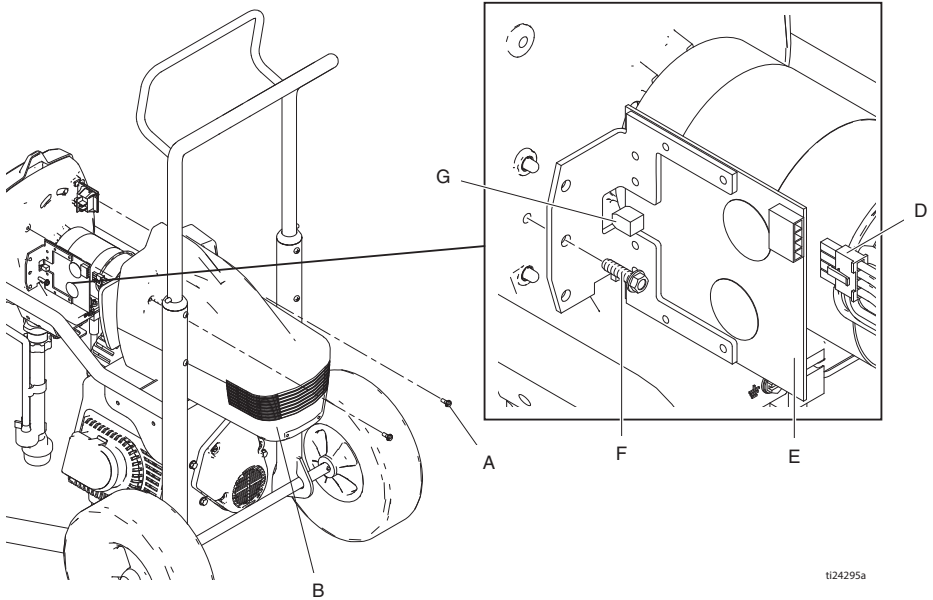

ti24295a

Compressor Control Board Replacement

Compressor Control Board Replacement

Disassembly

1. Unplug electrical cord and **Relieve Pressure**.
2. Loosen IEC cord clamp screw and remove IEC plug from compressor.
4. Remove four screws. Tip compressor down and forward to remove from sprayer. Place compressor on workbench.

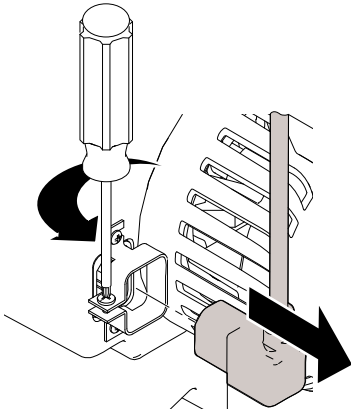

3. Remove air hose from compressor and remove outlet fitting from compressor.

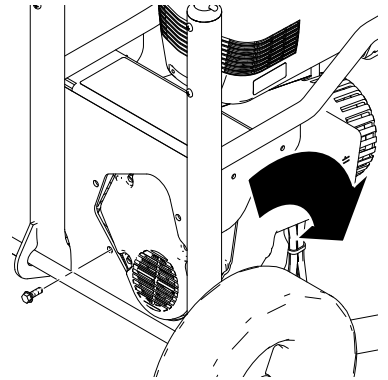
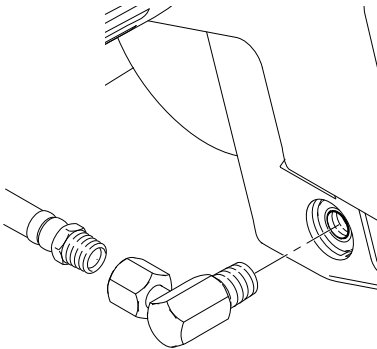

5. Remove two screws and IEC cord clamp. Remove two screws and compressor shroud.

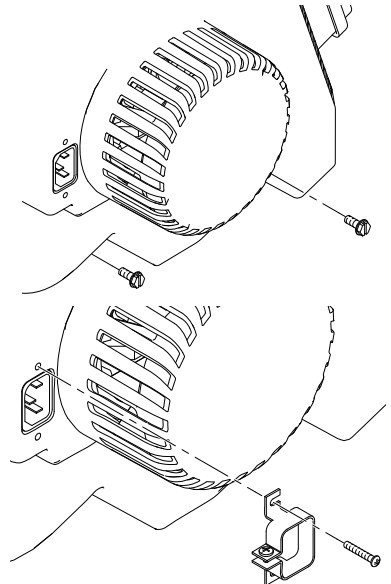

Compressor Control Board Replacement

6. Disconnect motor harness and power leads from control board to IEC plug. Remove screw that mounts control board.

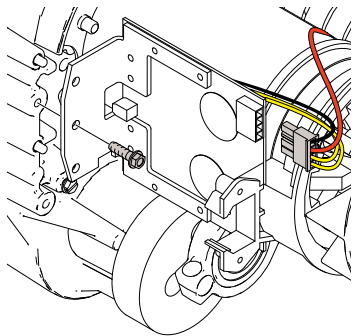

2. Slide shroud back on and install two screws. Install IEC cord clamp with two screws.

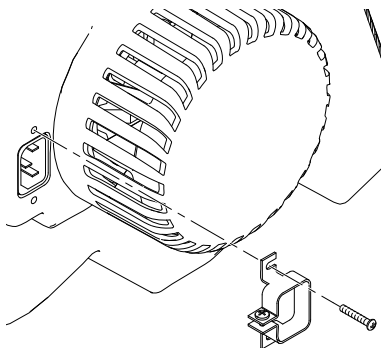
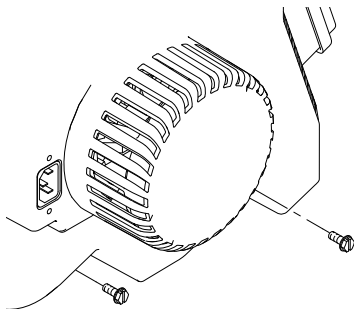

Assembly

1. Install replacement control board with mounting screw. Connect motor wiring harness and power leads to IEC plug.

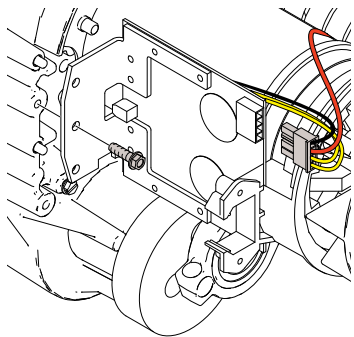

3. Slide compressor back into place on sprayer frame. Install four screws.

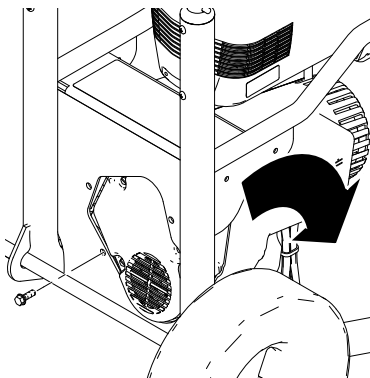

Compressor Control Board Replacement

4. Install air outlet fitting and air hose.

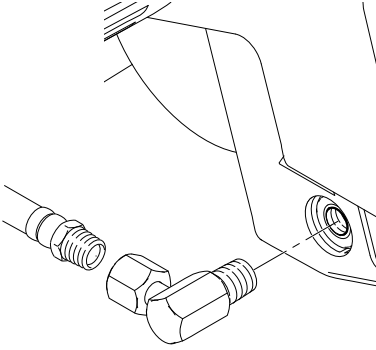

5. Install compressor power cord.
Install IEC plug and tighten cord clamp securely.

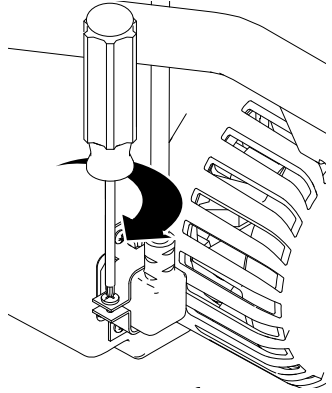

Wiring Diagrams

Wiring Diagrams

120V

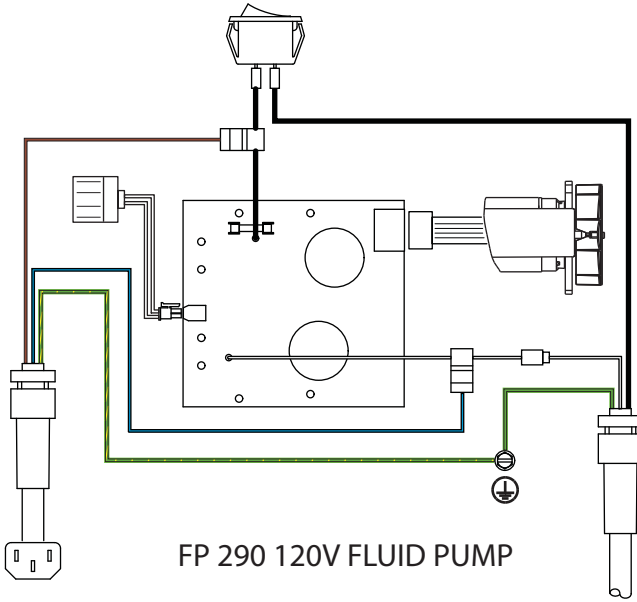

120V

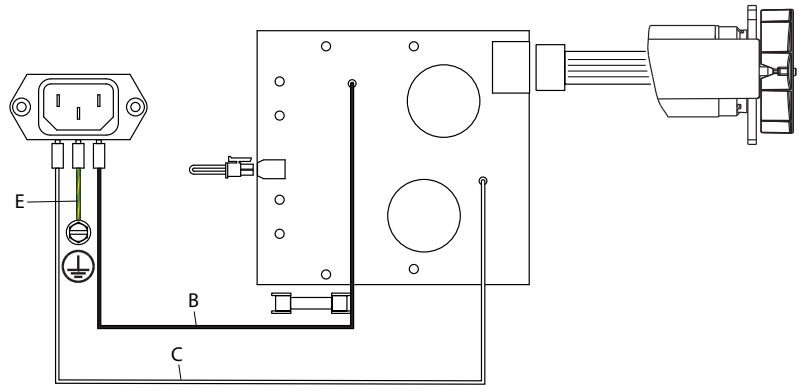
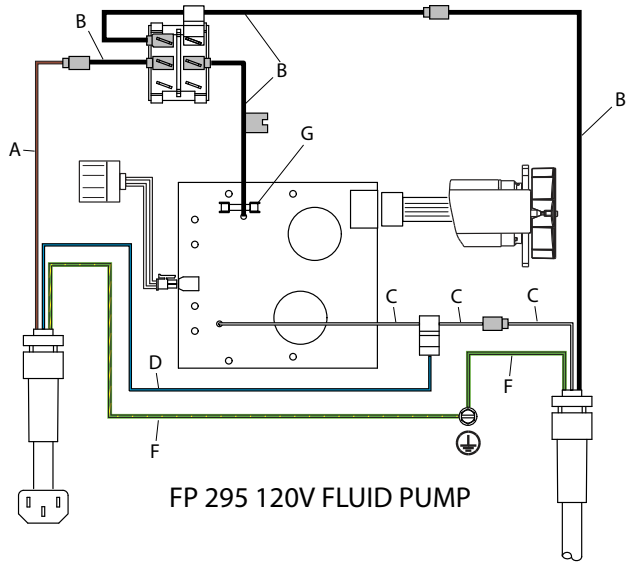

FP 290/295 120V COMPRESSOR

t22571a1

A	Red Wire	E	Striped Wire
B	Black Wire	F	Green/Yellow Wire
C	White Wire	G	Fuse
D	Blue wire		

Wiring Diagrams

240V

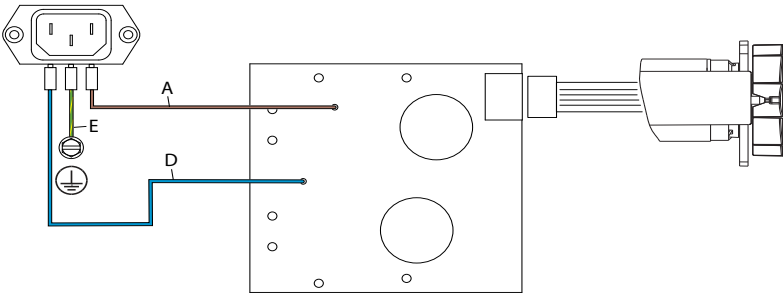
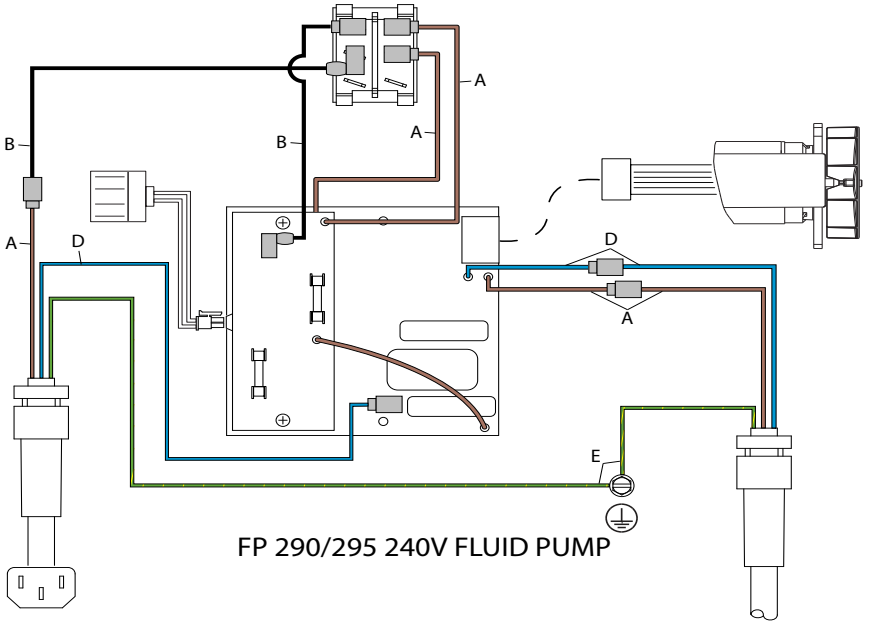

t113426a

A	Brown Wire	E	Green/Yellow Wire
B	Black Wire	F	Compressor Fuse
D	Blue Wire	G	Fluid Pump Fuse

All written and visual data contained in this document reflects the latest product information available at the time of publication.

Graco reserves the right to make changes at any time without notice.

Original instructions. This manual contains English. MM 313761

Graco Headquarters: Minneapolis
International Offices: Belgium, China, Japan, Korea

GRACO INC. AND SUBSIDIARIES • P.O. BOX 1441 • MINNEAPOLIS MN 55440-1441 • USA

Copyright 2009, Graco Inc. All Graco manufacturing locations are registered to ISO 9001.

www.graco.com
Revision B, February 2015