

Check Valve Repair Kit 24M611, 24U755

3A2338C
EN

- For use with models 24M054, 24M055, 24M056, 24M057 24M005, 24M006, 24L998, 24L999, 24M507, 16W908*, 16X099*, 16Y534*, 16Y535*, 16Y536*, 16Y910*, 16Y912*, 16Y913*, 17N350*, 17N352*, 17N354* only -



Important Safety Instructions

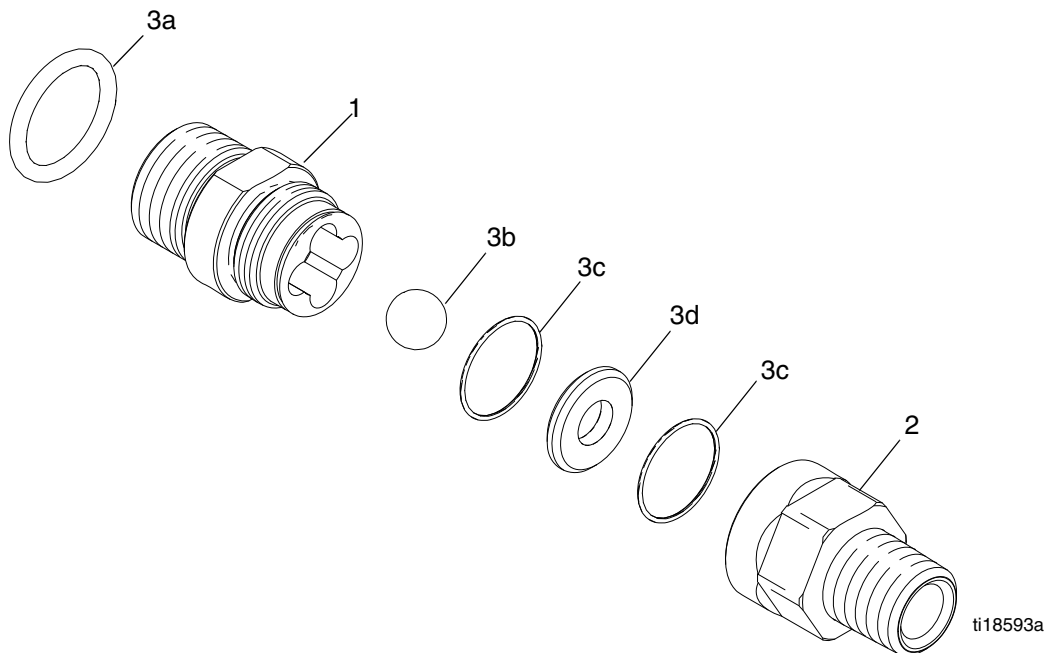

For detailed sprayer information and warnings, see Operation manual included with sprayer.



Ref. Part	Description	Qty.
1	HOUSING, ball, check valve	
2	HOUSING, seat, check valve	
3	24M725 Check Valve Repair Kit (includes 3a, 3b, 3c, 3d)	1
3a	O-RING	1
3b	BALL, ceramic, .500	1
3c	O-RING, special	2
3d	SEAT, foot valve, carbide	1

**3a o-ring not used on these sprayers.*

Pressure Relief Procedure

						
<p>To help prevent injection injuries, follow this procedure when you stop spraying and before you service or clean the sprayer, remove parts, or repair leaks.</p>						

1. Turn power **OFF**. Wait 7 seconds for power to dissipate.

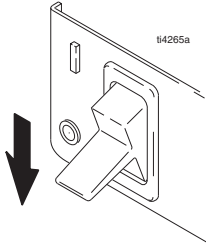

2. Lock gun trigger safety.

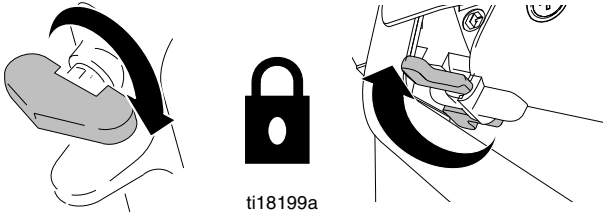

3. Remove guard and SwitchTip.

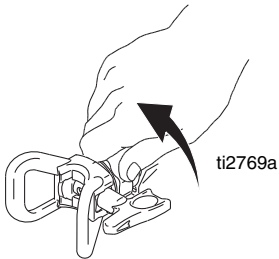

4. Turn pressure to lowest setting. Trigger gun to relieve pressure.

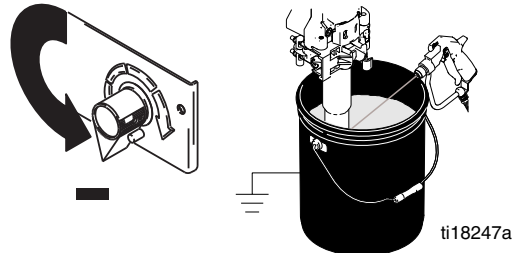

5. Put drain tube in pail. Turn prime valve down to DRAIN position.

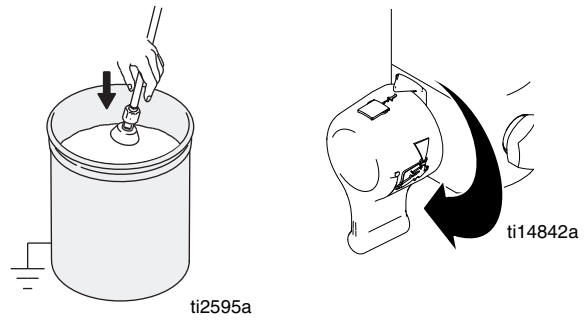

NOTE: Leave Spray/Prime valve in the PRIME position until you are ready to spray again.

If you suspect that the spray tip or hose is completely clogged or that pressure has not been fully relieved after following the steps above, VERY SLOWLY loosen the tip guard retaining nut or hose end coupling to relieve pressure gradually. Then loosen it completely. Clear the tip or hose obstruction.

Check Valve Repair



1. Flush pump. Perform **Pressure Relief Procedure**, (see previous page).
2. Separate drain hose from sprayer.

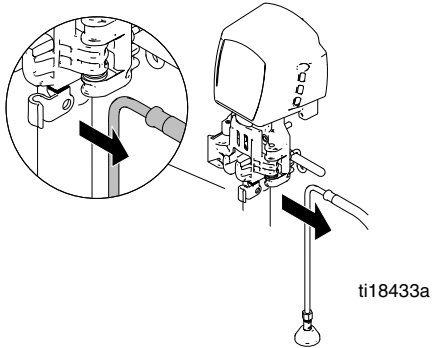

3. Disconnect paint hose from check valve.

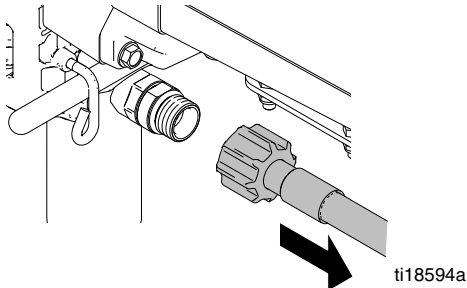

4. Remove check valve assembly from pump.

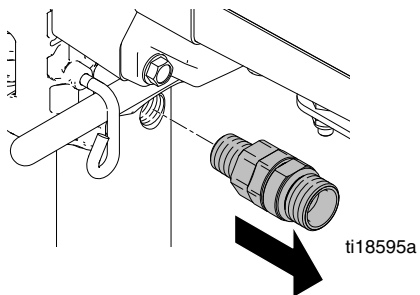

5. Remove check valve outlet fitting.

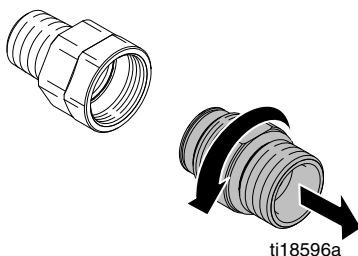

6. Replace o-rings (4), ball housing (2), ceramic ball (3), and seat (5).

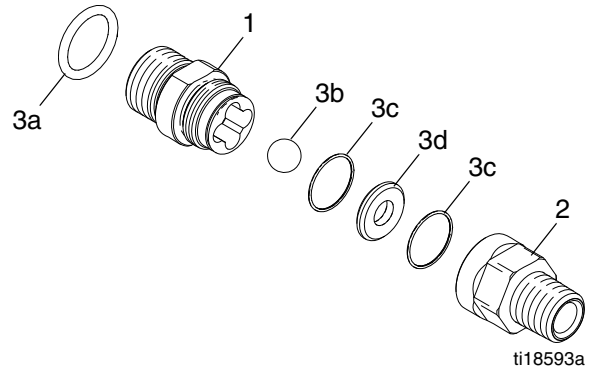

7. Apply pipe sealant to check valve inlet threads.

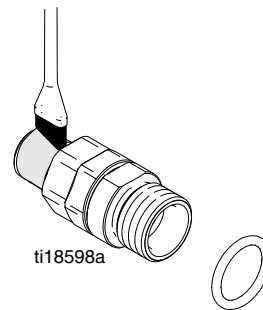

8. Use 1.5 in. wrench to securely tighten check valve to pump.

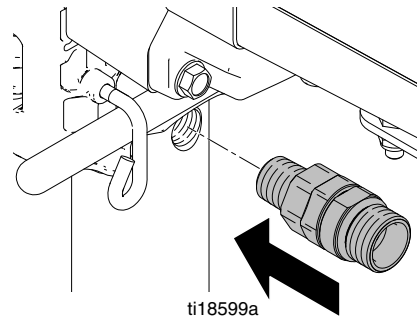

9. Connect paint hose and hand tighten to 70 in-lb (8 N•m).

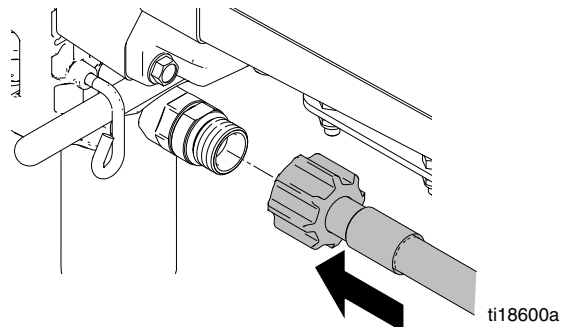

10. Verify latch lock is in locked position.

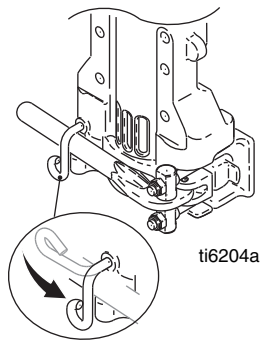

11. Attach drain hose to sprayer.

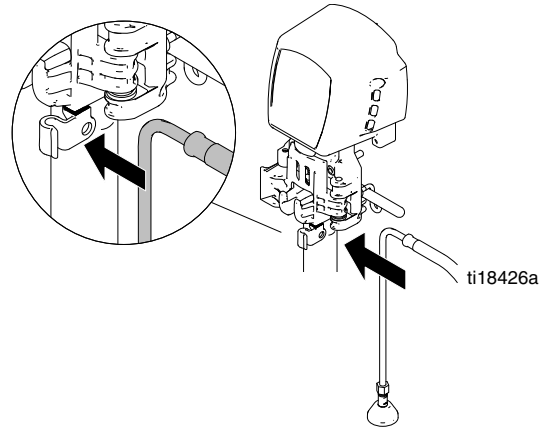

12. Fill pump with Graco TSL until fluid flows onto top of seal.

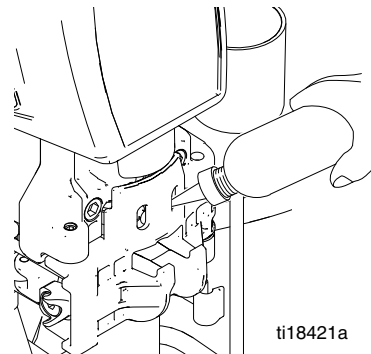

All written and visual data contained in this document reflects the latest product information available at the time of publication. Graco reserves the right to make changes at any time without notice.

Original instructions. This manual contains English. MM 3A2338

Graco Headquarters: Minneapolis

International Offices: Belgium, China, Japan, Korea

GRACO INC. AND SUBSIDIARIES • P.O. BOX 1441 • MINNEAPOLIS MN 55440-1441 • USA

Copyright 2012, Graco Inc. All Graco manufacturing locations are registered to ISO 9001.

www.graco.com

Revised C, May 2017