

## Inlet Valve Replacement Kit 24J424 for Fine Finish Hand-Held Sprayers



3A1702A  
ENG



### IMPORTANT SAFETY INSTRUCTIONS

Read all warnings and instructions in this manual. Save these instructions.

## Pressure Relief Procedure

			
<p>Do not operate or spray near children. Do not aim the sprayer at, or spray any person or animal. Keep hands and other body parts away from the front of the sprayer. For example, do not try to stop the paint flow with any part of the body.</p> <p>This sprayer builds up an internal pressure of 1,700 psi during use. Follow this <b>Pressure Relief Procedure</b> whenever you stop spraying and before cleaning, checking, servicing, or transporting equipment to prevent serious injury.</p>			

1. Engage trigger lock.

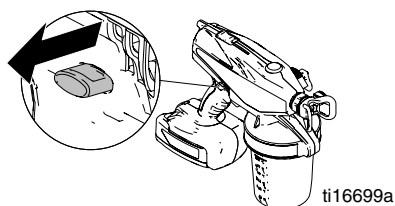

2. Put prime/pressure relief valve UP to release pressure.

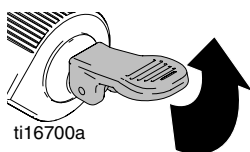

# Removal

Move sprayer to a non-hazardous area before servicing.			

1. Engage trigger lock and pull prime/pressure relief valve UP to release pressure.

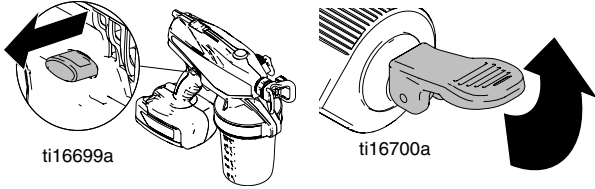

2. Remove material cup, suction tube, and battery.

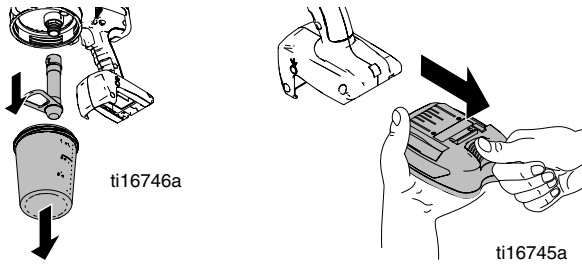

3. Hold sprayer upside-down and use wrench or socket to loosen and remove inlet fitting, inlet valve, and spring.

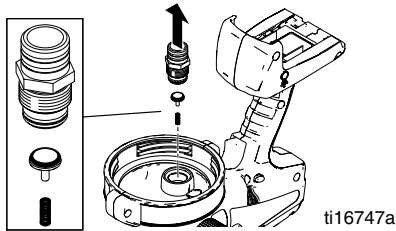

**NOTE:** Make sure the spring also comes out. Use needle-nose pliers to remove if needed. Inlet cavity should be completely empty (as shown below).

4. Clean as much excess material from inlet cavity as possible. Make sure you also clean spring (a), inlet valve (b), o-ring (c), and top of inlet fitting (d).

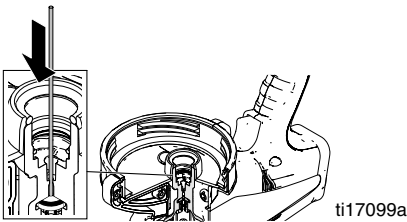

5. Use a thin wire to check that the outlet valve moves freely. If valve does not move freely, perform **Outlet Valve Repair** in sprayer operation manual.

# Installation

**NOTE:** Before installing, make sure o-ring (c) is installed on inlet valve (b).

1. Place inlet valve (b) with spring (a) on top of inlet fitting (d). Push inlet fitting up into pump cavity.

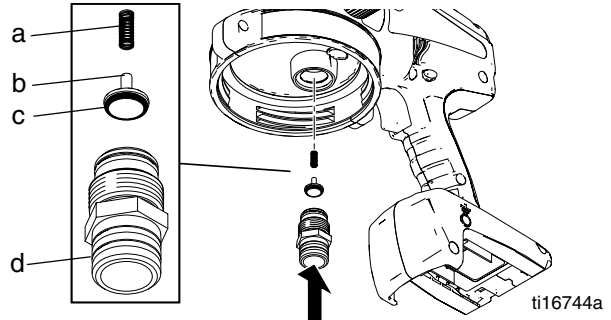

2. Hold inlet in place and turn sprayer upside-down. Remove inlet fitting and visually check to see that inlet valve has seated correctly.

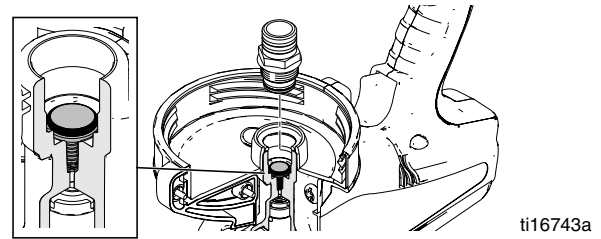

3. Replace inlet fitting and use wrench or socket to tighten to 10 ft-lb.

**NOTICE**

Do **NOT** over-tighten inlet fitting. Damage to the equipment will occur.

4. Use a pencil or thin rod to lightly push on inlet valve to make sure it moves up and down freely.

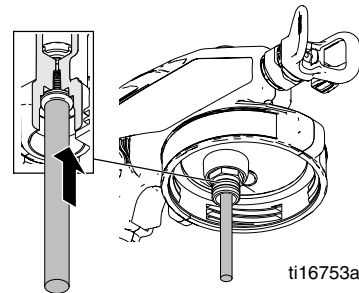

*All written and visual data contained in this document reflects the latest product information available at the time of publication. Graco reserves the right to make changes at any time without notice.*

Original instructions. This manual contains English. MM 3A1698  
Graco Headquarters: Minneapolis

International Offices: Belgium, China, Japan, Korea

GRACO INC. P.O. BOX 1441 MINNEAPOLIS, MN 55440-1441

www.graco.com

06/2011