

Pump for Drywall Feed Pump System

3A0912B
EN

-
- For water-based materials only -
 - Not for use in explosive atmospheres -
 - Not for use with quick-set materials -



READ ALL WARNINGS AND INSTRUCTIONS

Read all warnings and instructions in this manual.
Save these instructions.

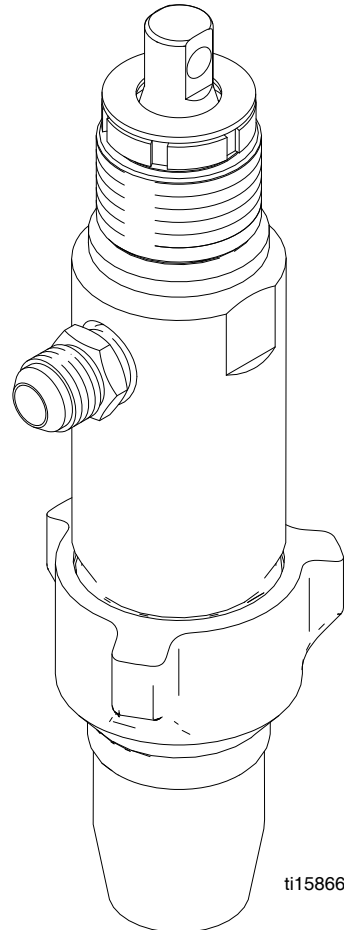

Maximum Working Pressure 2500 psi (17.2 MPa, 172 bar)

Model 24E957



Warning

The following warnings are for the setup, use, grounding, maintenance, and repair of this equipment. The exclamation point symbol alerts you to a general warning and the hazard symbols refer to procedure-specific risks. When these symbols appear in the body of this manual, refer back to these Warnings. Product-specific hazard symbols and warnings not covered in this section may appear throughout the body of this manual where applicable.

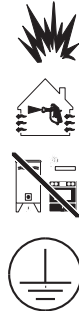
 WARNING	
	<p>ELECTRIC SHOCK HAZARD This equipment must be grounded. Improper grounding, setup, or usage of the system can cause electric shock.</p> <ul style="list-style-type: none"> • Turn off and disconnect power cord before servicing equipment. • Use only grounded electrical outlets. • Use only 3-wire extension cords. • Ensure ground prongs are intact on power and extension cords. • Do not expose to rain. Store indoors.
	<p>SKIN INJECTION HAZARD High-pressure fluid from dispensing device, hose leaks, or ruptured components will pierce skin. This may look like just a cut, but it is a serious injury that can result in amputation. Get immediate surgical treatment.</p> <ul style="list-style-type: none"> • Engage trigger lock when not dispensing. • Do not point dispensing device at anyone or at any part of the body. • Do not put your hand over the fluid outlet. • Do not stop or deflect leaks with your hand, body, glove, or rag. • Follow the Pressure Relief Procedure when you stop dispensing and before cleaning, checking, or servicing equipment. • Tighten all fluid connections before operating the equipment. • Check hoses and couplings daily. Replace worn or damaged parts immediately.
	<p>FIRE AND EXPLOSION HAZARD Flammable fumes, such as solvent and paint fumes, in work area can ignite or explode. To help prevent fire and explosion:</p> <ul style="list-style-type: none"> • Do not dispense flammable or combustible materials near an open flame or sources of ignition such as cigarettes, motors, and electrical equipment. • Material or solvent flowing through the equipment is able to result in static electricity. Static electricity creates a risk of fire or explosion in the presence of material or solvent fumes. All parts of the system, including the pump, hose assembly, dispenser, and objects in and around the work area shall be properly grounded to protect against static discharge and sparks. Use Graco conductive or grounded high-pressure airless material hoses. • Verify that all containers and collection systems are grounded to prevent static discharge. • Connect to a grounded outlet and use grounded extensions cords. Do not use a 3-to-2 adapter. • Do not use a material or a solvent containing halogenated hydrocarbons. • Keep work area well-ventilated. Keep a good supply of fresh air moving through the area. Keep pump assembly in a well ventilated area. • Do not smoke in the work area. • Do not operate light switches, engines, or similar spark producing products in the work area. • Keep area clean and free of material or solvent containers, rags, and other flammable materials. • Know the contents of the materials and solvents being dispensed. Read all Material Safety Data Sheets (MSDS) and container labels provided with the materials and solvents. Follow the material and solvents manufacturer's safety instructions. • Fire extinguisher equipment shall be present and working. • Drywall feed pump generates sparks. When flammable liquid is used in or near the drywall feed pump or for flushing or cleaning, keep unit at least 20 feet (6 m) away from explosive vapors.

! WARNING



MOVING PARTS HAZARD

Moving parts can pinch, cut or amputate fingers and other body parts.

- Keep clear of moving parts.
- Do not operate equipment with protective guards or covers removed.
- Pressurized equipment can start without warning. Before checking, moving, or servicing equipment, follow the **Pressure Relief Procedure** and disconnect all power sources.



EQUIPMENT MISUSE HAZARD

Misuse can cause death or serious injury.

- Always wear appropriate gloves, eye protection, and a respirator or mask when dispensing.
- Do not operate or dispense near children. Keep children away from equipment at all times.
- Do not overreach or stand on an unstable support. Keep effective footing and balance at all times.
- Stay alert and watch what you are doing.
- Do not leave the unit energized or under pressure while unattended. When the unit is not in use, turn off the unit and follow the **Pressure Relief Procedure** for turning off the unit.
- Do not operate the unit when fatigued or under the influence of drugs or alcohol.
- Do not kink or over-bend the hose.
- Do not expose the hose to temperatures or to pressures in excess of those specified by Graco.
- Do not use the hose as a strength member to pull or lift the equipment.



PRESSURIZED ALUMINUM PARTS HAZARD

Use of fluids that are incompatible with aluminum in pressurized equipment can cause serious chemical reaction and equipment rupture. Failure to follow this warning can result in death, serious injury, or property damage.

- Do not use 1,1,1-trichloroethane, methylene chloride, other halogenated hydrocarbon solvents or fluids containing such solvents.
- Many other fluids may contain chemicals that can react with aluminum. Contact your material supplier for compatibility.



PERSONAL PROTECTIVE EQUIPMENT

You must wear appropriate protective equipment when operating, servicing, or when in the operating area of the equipment to help protect you from serious injury, including eye injury, hearing loss, inhalation of toxic fumes, and burns. This equipment includes but is not limited to:

- Protective eyewear, and hearing protection.
- Respirators, protective clothing, and gloves as recommended by the fluid and solvent manufacturer.

Pressure Relief Procedure



1. Turn flow control knob to fully counterclockwise.

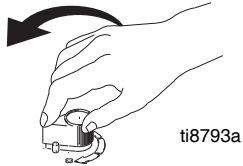

2. Place deflector in hopper or suitable container.

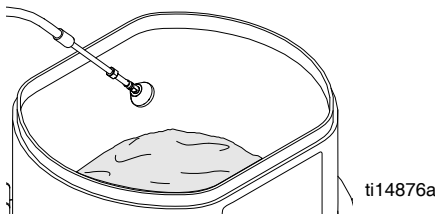

3. Turn prime valve handle to PRESSURE RELIEF position.

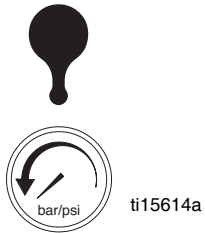

4. Display will read "----" when all pressure is relieved.

Power Module Removal

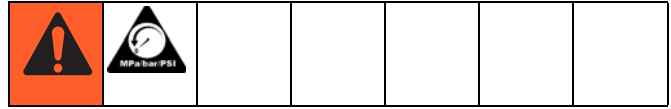

1. Perform **Pressure Relief Procedure**. Unplug power cord.
2. Release hopper adapter clamp (158).

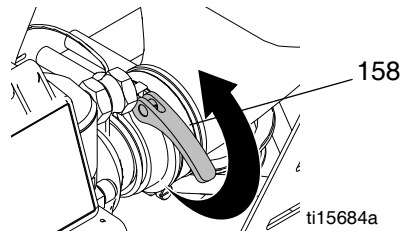

3. Loosen rod clamp knob (112) on front of pump module and push rod down.

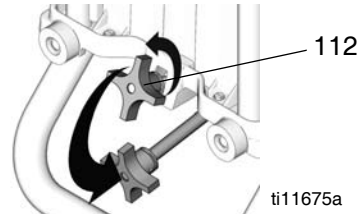

4. Lift and pull power module (153) off of unit.
NOTE: Power module weighs approximately 85 lb.

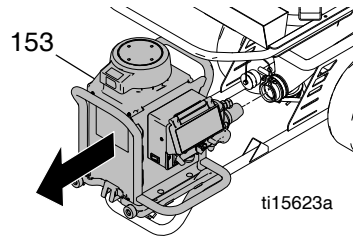

5. Install hopper plug (117) if needed.

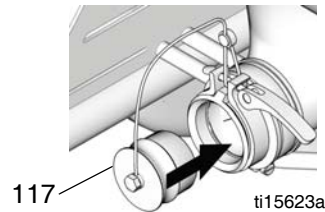

Power Module Installation

1. Remove hopper plug (117) if installed.
2. Replace power (153) module and insert pump outlet into hopper inlet.

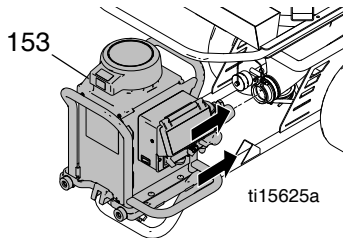

3. Pull rod clamp up and tighten knob (112) on front of pump module.

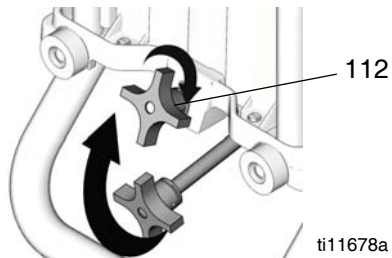

4. Fasten hopper adapter clamp (158).

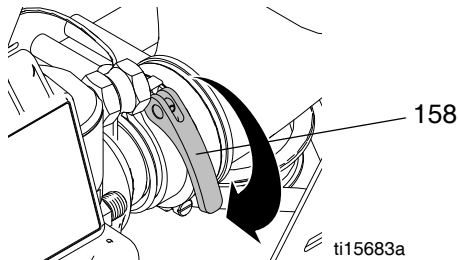

Pump Removal

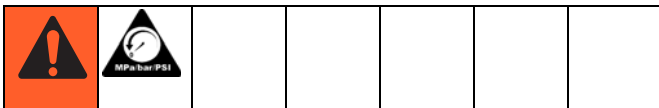

1. Perform **Pressure Relief Procedure**, see page 4.
2. Remove **Power Module**, see page 4.
3. Disconnect material hose (79) from pump (18a).

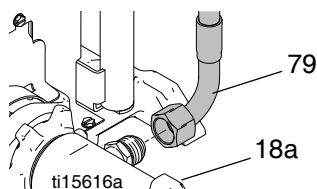

4. Loosen two screws (40) and remove pump rod shield (48).

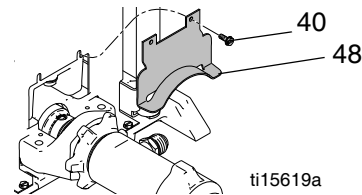

5. Turn flow control knob to a very low setting and turn prime valve handle to TOOL FILL position (**JOG** mode will appear in display). Use ON/OFF switch or turn control knob OFF to stop pump when pin is visible.



6. Use screwdriver to press pin (7b) out of pump.

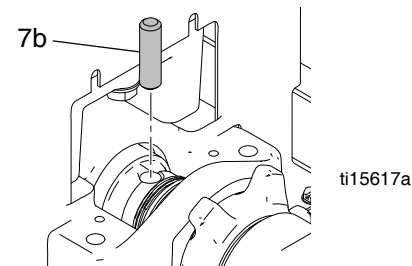

NOTE: Pin should be removed by pressing the pin out through the bottom side of the pump. Make sure to control the pump pin when removing so that it does not fall into the pump module.

7. Use hammer to loosen pump retaining nut (22).

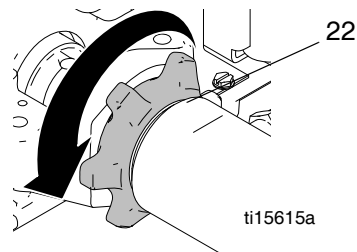

8. Unscrew and remove pump (18a) from module.

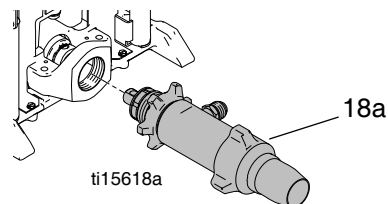

Pump Installation

1. Extend pump piston rod 1.5 in.

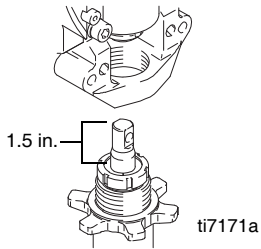

2. Install pump pin (7b). Verify retaining spring is in groove of connecting rod.

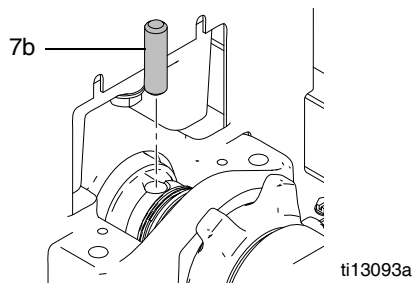

NOTE: Pin should be installed from the top side of the pump. Make sure to control the pump pin when installing so that it does not fall into the pump module.

3. Push pump up until pump threads engage.

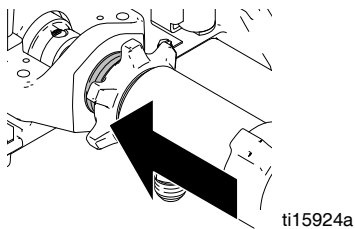

4. Screw in pump until threads are flush with drive housing opening.

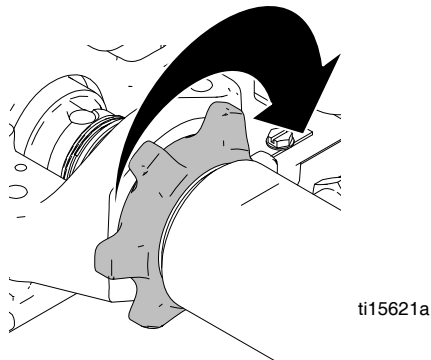

5. Align pump outlet to right side so that hose can be reassembled.

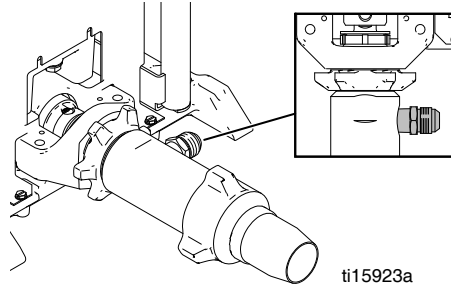

6. Screw jam nut up toward drive housing until nut stops. Tighten jam nut by hand, then tap 1/8 to 1/4 turn with a 20 oz. (maximum) hammer to approximately 75 ± 5 ft-lb (102 N•m).

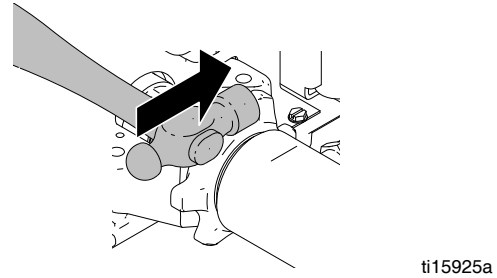

7. Replace pump rod shield (48) and torque two screws (40) to 30 - 34 in-lb.

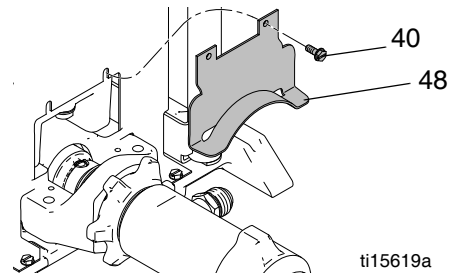

8. Reconnect material hose (79) to pump (18a).

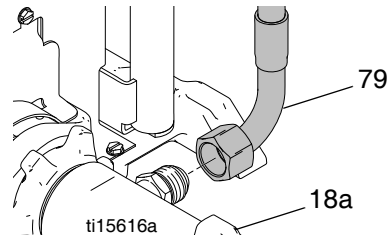

9. Replace **Power Module**, see page 5.

Pump Service

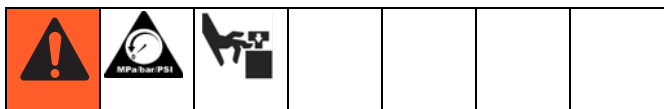

Disassemble the Pump

1. Perform **Pressure Relief Procedure**, page 4.
2. Perform **Power Module Removal**, page 4.
3. Perform **Pump Removal**, page 5.
4. Remove packing nut (312) and throat adjustment spacer (302).

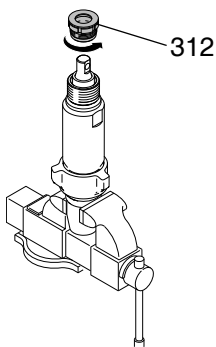

5. Unscrew intake valve (319) from cylinder (304).

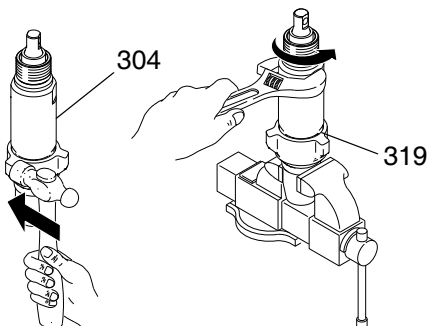

6. Disassemble intake valve (319). Clean and inspect. O-ring (315a) may require a pick for removal.
NOTE: if seat and ball need to be replaced, Carbide Repair Kit 24F268 is available.

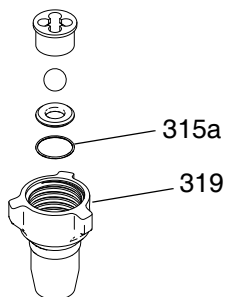

7. Tap piston rod out of cylinder with a hammer or flip over and tap piston rod out against a bench.

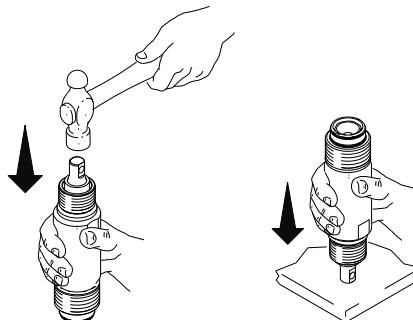

8. Remove piston (311) from sleeve (306), or remove sleeve from cylinder.

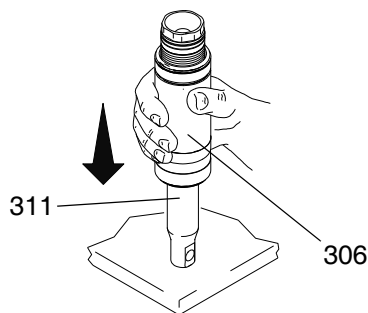

COMPONENT RUPTURE HAZARD					
Do not clean or wipe the piston valve threads. Cleaning the piston valve threads could destroy the special sealing patch and cause the piston valve to come loose during operation, causing pump bursting and possible bodily injury.					

9. Unscrew piston valve (313) from piston rod (311). Clean and inspect parts. The piston has a special thread locking/sealing patch. Do not remove the patch. The patch allows four disassembly/assembly procedures before it is necessary to apply sealant to threads.

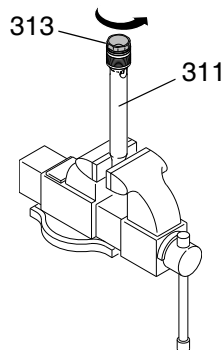

- Remove packings and glands from piston rod. Discard packings and glands. Remove piston wiper and back-up washer from piston rod. Discard piston wiper and back-up washer.

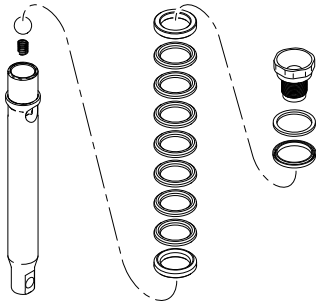

- Remove throat packings and glands from cylinder. Discard throat packings and glands.

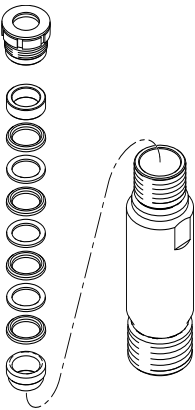

- Install ball (315c) in piston rod. If thread sealant is applied to piston valve threads, ensure that none gets on ball.

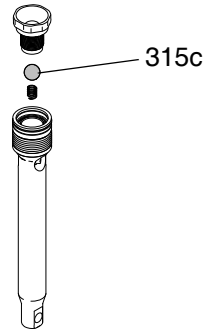

- Tighten piston valve to 100 ± 5 ft-lb.

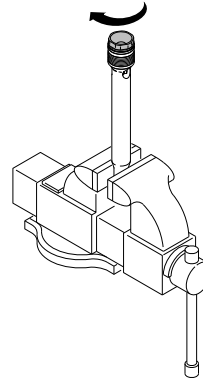

- Soak all leather packings in SAE 30W oil for 1 hour minimum prior to assembly. Place male gland (315p) in cylinder. Alternately stack UHMWPE and packings (note orientation). Place female gland (315g) in top of cylinder. Seat packings.

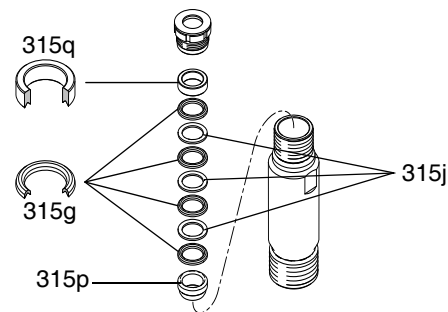

Assemble the Pump

- Soak all leather packings in SAE 30W oil for 1 hour minimum prior to assembly. Stack male gland (315k) on piston rod. Alternately stack UHMWPE and packings (note orientation) on piston rod. Install female gland (315f). The special sealing patch on piston valve threads is good for four repackings. Install piston wiper (315e) and back-up washer.

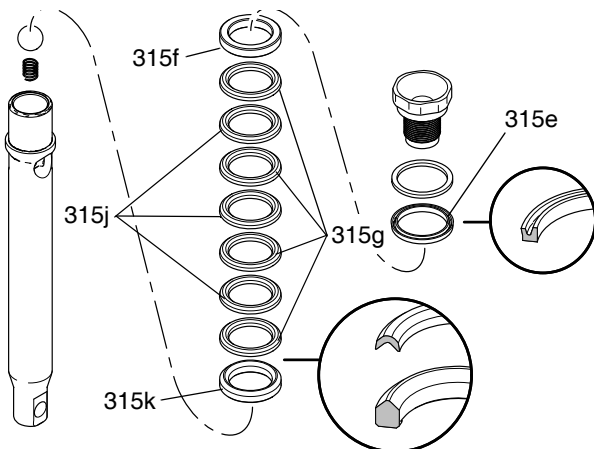

- Install packing nut (312). Install throat adjustment spacer (302) onto packing nut. Loosely install packing nut into cylinder.

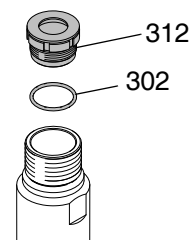

6. Grease piston packings and sleeve top edge.

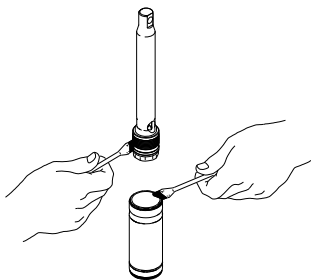

7. Carefully slide piston assembly into top of sleeve.

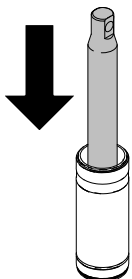

8. Grease top inch or two of piston rod that will go through the cylinder throat packings.

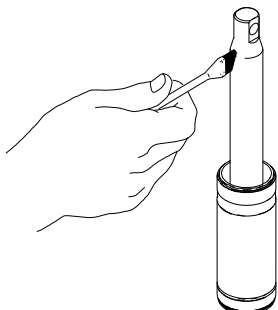

9. Grease o-ring (315m) and place on sleeve. Slide sleeve/piston rod assembly into bottom of cylinder. Replace o-ring (315n) if desired. **NOTE:** O-ring (315n) is not required for safe pump operation.

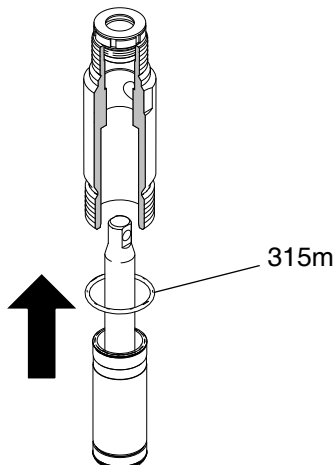

10. Reassemble intake valve with new o-ring (315a), seat (309a) and ball (315b). Seat may be flipped over and used on other side. Clean seat thoroughly. Place intake spring (315r) on top of ball guide (317).

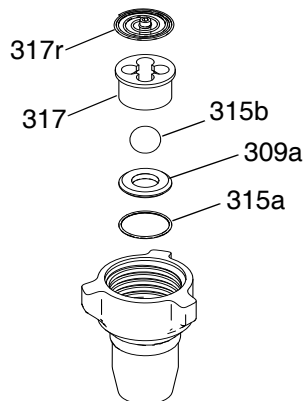

11. Install intake valve on cylinder. If a wrench is used, torque to 200 ± 15 ft-lb. If a wrench is not used, be sure intake valve is tight against cylinder.

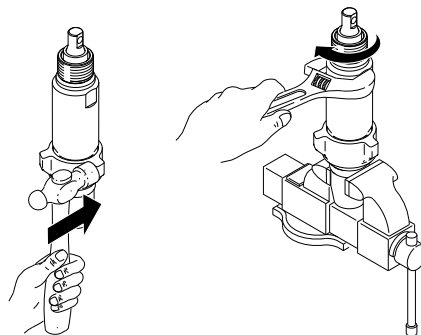

12. Torque seal and packing nut (312) down onto throat adjustment spacer (302) to 140 ± 10 in-lb. Remove throat adjustment spacer (302) when pump packings begin to leak after too much use. Then tighten packing nut down until leakage stops or lessens. This allows approximately 100 gallons of additional operation before a repacking is required.

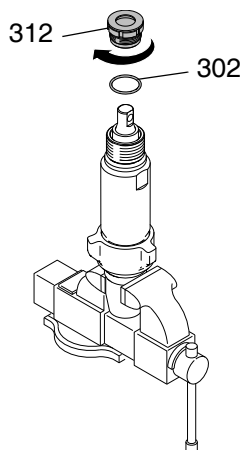

Graco Standard Warranty

Graco warrants all equipment referenced in this document which is manufactured by Graco and bearing its name to be free from defects in material and workmanship on the date of sale to the original purchaser for use. With the exception of any special, extended, or limited warranty published by Graco, Graco will, for a period of twelve months from the date of sale, repair or replace any part of the equipment determined by Graco to be defective. This warranty applies only when the equipment is installed, operated and maintained in accordance with Graco's written recommendations.

This warranty does not cover, and Graco shall not be liable for general wear and tear, or any malfunction, damage or wear caused by faulty installation, misapplication, abrasion, corrosion, inadequate or improper maintenance, negligence, accident, tampering, or substitution of non-Graco component parts. Nor shall Graco be liable for malfunction, damage or wear caused by the incompatibility of Graco equipment with structures, accessories, equipment or materials not supplied by Graco, or the improper design, manufacture, installation, operation or maintenance of structures, accessories, equipment or materials not supplied by Graco.

This warranty is conditioned upon the prepaid return of the equipment claimed to be defective to an authorized Graco distributor for verification of the claimed defect. If the claimed defect is verified, Graco will repair or replace free of charge any defective parts. The equipment will be returned to the original purchaser transportation prepaid. If inspection of the equipment does not disclose any defect in material or workmanship, repairs will be made at a reasonable charge, which charges may include the costs of parts, labor, and transportation.

THIS WARRANTY IS EXCLUSIVE, AND IS IN LIEU OF ANY OTHER WARRANTIES, EXPRESS OR IMPLIED, INCLUDING BUT NOT LIMITED TO WARRANTY OF MERCHANTABILITY OR WARRANTY OF FITNESS FOR A PARTICULAR PURPOSE.

Graco's sole obligation and buyer's sole remedy for any breach of warranty shall be as set forth above. The buyer agrees that no other remedy (including, but not limited to, incidental or consequential damages for lost profits, lost sales, injury to person or property, or any other incidental or consequential loss) shall be available. Any action for breach of warranty must be brought within two (2) years of the date of sale.

GRACO MAKES NO WARRANTY, AND DISCLAIMS ALL IMPLIED WARRANTIES OF MERCHANTABILITY AND FITNESS FOR A PARTICULAR PURPOSE, IN CONNECTION WITH ACCESSORIES, EQUIPMENT, MATERIALS OR COMPONENTS SOLD BUT NOT MANUFACTURED BY GRACO. These items sold, but not manufactured by Graco (such as electric motors, switches, hose, etc.), are subject to the warranty, if any, of their manufacturer. Graco will provide purchaser with reasonable assistance in making any claim for breach of these warranties.

In no event will Graco be liable for indirect, incidental, special or consequential damages resulting from Graco supplying equipment hereunder, or the furnishing, performance, or use of any products or other goods sold hereto, whether due to a breach of contract, breach of warranty, the negligence of Graco, or otherwise.

FOR GRACO CANADA CUSTOMERS

The Parties acknowledge that they have required that the present document, as well as all documents, notices and legal proceedings entered into, given or instituted pursuant hereto or relating directly or indirectly hereto, be drawn up in English. Les parties reconnaissent avoir convenu que la rédaction du présente document sera en Anglais, ainsi que tous documents, avis et procédures judiciaires exécutés, donnés ou intentés, à la suite de ou en rapport, directement ou indirectement, avec les procédures concernées.

Graco Information

For the latest information about Graco products, visit www.graco.com.

For patent information, see www.graco.com/patents.

TO PLACE AN ORDER, contact your Graco distributor or call 1-800-690-2894 to identify the nearest distributor.

All written and visual data contained in this document reflects the latest product information available at the time of publication. Graco reserves the right to make changes at any time without notice.

Original instructions. This manual contains English. MM 3A0912

Graco Headquarters: Minneapolis

International Offices: Belgium, China, Japan, Korea

GRACO INC. AND SUBSIDIARIES • P.O. BOX 1441 • MINNEAPOLIS MN 55440-1441 • USA
Copyright 2010, Graco Inc. All Graco manufacturing locations are registered to ISO 9001.

www.graco.com

Revision B, August 2017