

Red Alert Filter

3A3940B

EN

For high pressure, medium volume grease lubrication systems only.

Model: 17L366

3000 psi (21 MPa, 210 bar) Maximum Working Pressure

2 gpm (7.57 lpm) Flow Capacity

36 square inch (230 cm²) Filtering Area

380 micron Filtration



Important Safety Instructions



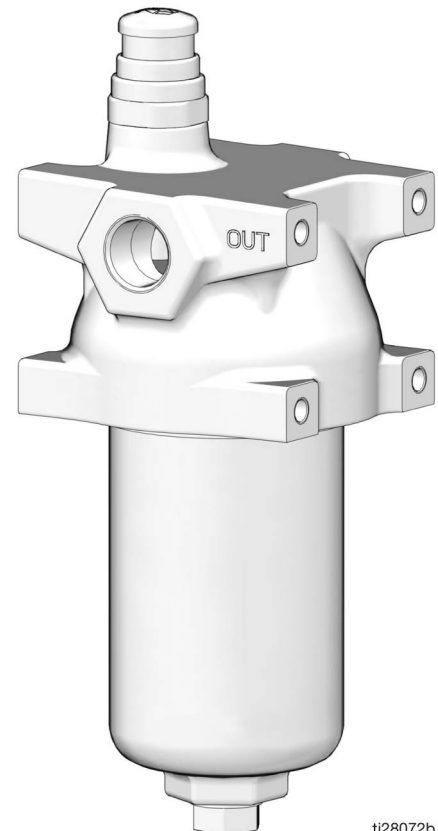





Read all warnings and instructions in this manual before using the equipment. Be familiar with the proper control and usage of the equipment. Save these instructions.





ti28072b

Safety Symbols

The following safety symbols appear throughout this manual and on warning labels. Read the table below to understand what each symbol means.

Symbol	Meaning
	Equipment Misuse Hazard
	Moving Parts Hazard
	Skin Injection Hazard
	Skin Injection Hazard
	Splash Hazard
	Ground Equipment
	Read Manual
	Follow Pressure Relief Procedure

Symbol	Meaning
	Wear Personal Protective Equipment
	Do Not Place Hands or Other Body Parts Near Fluid Outlet
	Do Not Stop Leaks with Hand, Body, Glove or Rag





Safety Alert Symbol

This symbol indicates: Attention! Become Alert! Look for this symbol throughout the manual to indicate important safety messages.

Warnings

The following warnings apply throughout this manual. Read, understand, and follow the warnings before using this equipment. Failure to follow these warnings can result in serious injury.

 <h1 style="margin: 0;">WARNING</h1>	
	<p>SKIN INJECTION HAZARD</p> <p>High-pressure fluid from dispensing device, hose leaks, or ruptured components will pierce skin. This may look like just a cut, but it is a serious injury that can result in amputation. Get immediate surgical treatment.</p>
	<ul style="list-style-type: none"> • Do not point dispensing device at anyone or at any part of the body. • Do not put your hand over the fluid outlet. • Do not stop or deflect leaks with your hand, body, glove, or rag. • Follow the Pressure Relief Procedure when you stop dispensing and before cleaning, checking, or servicing equipment. • Tighten all fluid connections before operating the equipment. • Check hoses and couplings daily. Replace worn or damaged parts immediately.
	
	
	
	

WARNING



EQUIPMENT MISUSE HAZARD

Misuse can cause death or serious injury.



- Do not operate the unit when fatigued or under the influence of drugs or alcohol.
- Do not exceed the maximum working pressure or temperature rating of the lowest rated system component. See **Technical Specifications** in all equipment manuals.
- Use fluids and solvents that are compatible with equipment wetted parts. See **Technical Specifications** in all equipment manuals. Read fluid and solvent manufacturer's warnings. For complete information about your material, request Safety Data Sheets (SDSs) from distributor or retailer.
- Turn off all equipment and follow the **Pressure Relief Procedure** when equipment is not in use.
- Check equipment daily. Repair or replace worn or damaged parts immediately with genuine manufacturer's replacement parts only.
- Do not alter or modify equipment. Alterations or modifications may void agency approvals and create safety hazards.
- Make sure all equipment is rated and approved for the environment in which you are using it.
- Use equipment only for its intended purpose. Call your distributor for information.
- Route hoses and cables away from traffic areas, sharp edges, moving parts, and hot surfaces.
- Do not kink or over bend hoses or use hoses to pull equipment.
- Keep children and animals away from work area.
- Comply with all applicable safety regulations.



PERSONAL PROTECTIVE EQUIPMENT

Wear appropriate protective equipment when in the work area to help prevent serious injury, including eye injury, hearing loss, inhalation of toxic fumes, and burns. Protective equipment includes but is not limited to:

- Protective eyewear, and hearing protection.
- Respirators, protective clothing, and gloves as recommended by the fluid and solvent manufacturer.

Installation

Pressure Relief Procedure



Follow the Pressure Relief Procedure whenever you see this symbol.



This equipment stays pressurized until pressure is manually relieved. To help prevent serious injury from pressurized fluid, such as skin injection, splashing fluid and moving parts, follow the Pressure Relief Procedure when you stop dispensing and before cleaning, checking, or servicing the equipment.

1. Turn off the power supply to the pump where the filter is installed.
2. Place a fluid container (fc) (user supplied) below the drain valve (B) to collect excess fluid that drains (FIG. 1).

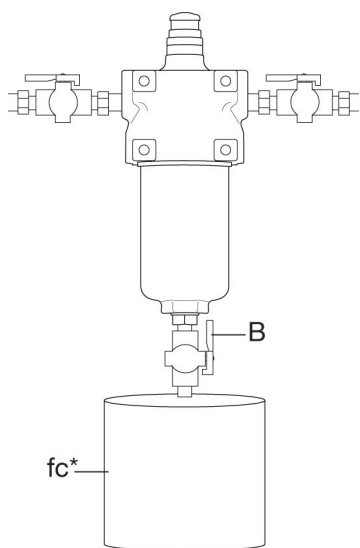

* User supplied ti28366b

FIG. 1

3. Loosen the filter inlet fitting using two wrenches working in opposite directions.
4. Loosen the filter outlet fitting using two wrenches working in opposite directions.
5. Open the drain valve (B) (FIG. 1).

Fluid Drain Valve (required)



A fluid drain valve must be installed in the base of each fluid filter. The drain valve relieves fluid pressure in the filter to reduce the risk of serious injury, such as fluid injection and fluid splashing in the eyes or on the skin.

To install the fluid drain valve:

1. Remove the 3/4 UNF plug (12) from the bottom of the filter.
2. Install a high pressure adapter (A) and drain valve (B) (FIG. 2).

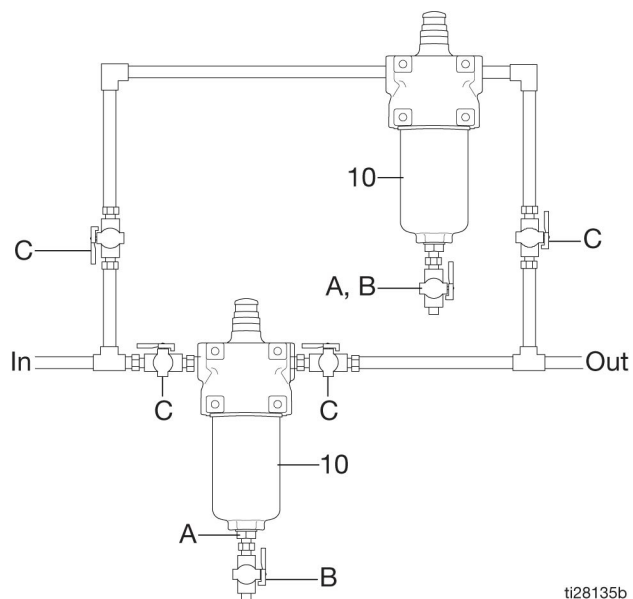

ti28135b

FIG. 2

Key

- A High Pressure Adapter
- B Drain Valve
- C Shut off Valve
- 10 Filter bowl

Dual Filter System

The referenced letters used in the following instructions refer to FIG. 3.

A dual filter system redirects the fluid to another filter while one filter is being cleaned or serviced.

1. Install two filters (10).
2. Install four shut off valves (C); one at each filter and outlet, to redirect the fluid and isolate the filter not in use.

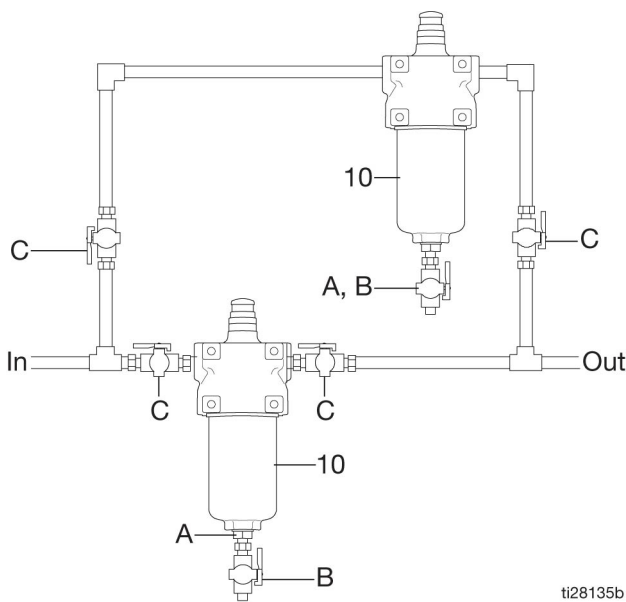

FIG. 3

Filter Bypass System

The referenced letters used in the following instructions refer to FIG. 4.

The filter bypass system redirects the fluid through pipes and bypasses the filter while cleaning or servicing the filter.

1. Install the filter (10) and bypass pipes.
2. Install four shut off valves (C); one each at the filter inlet; the filter outlet, the bypass pipe inlet and the bypass pipe outlet. These valves redirect the fluid and isolate the filter not in use.

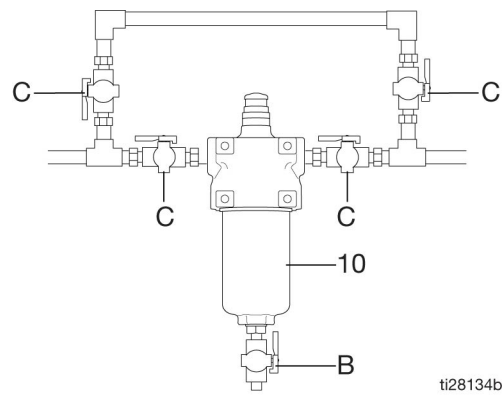

FIG. 4

Recycling and Disposal

End of Product Life

At the end of the product's useful life, dismantle and recycle it in a responsible manner.

- Perform the **Pressure Relief Procedure**, page 5.
- Drain and dispose of fluids according to applicable regulations. Refer to the material manufacturer's Safety Data Sheet.
- Deliver remaining product to a recycling facility.

Repair

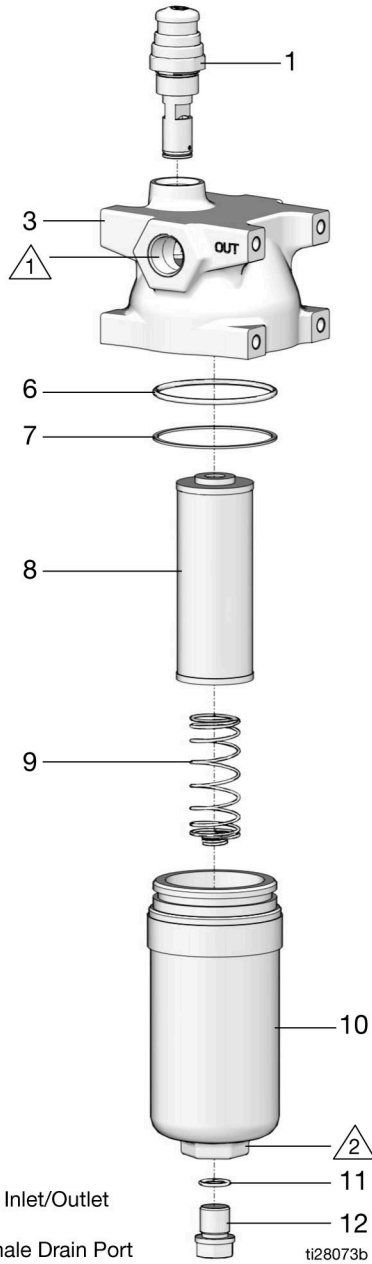

- △ 1 3/4 in. NPT Female Inlet/Outlet
- △ 2 3/4 in.-16 UNF Female Drain Port

Parts

Ref	Part No.	Description	Qty
1	25M213	INDICATOR, filter	1
3*	17L906	HOUSING, filter	1
6*	104445	O-RING, fluoroelastomer	1
7*	104443	O-RING, backup, fluoroelastomer	1
8*	129031	ELEMENT, filter, 45 mesh (380 micron)	1
9*	17L928	SPRING, element	1
10*	17L907	BOWL, filter	1
11*	104444	O-RING, fluoroelastomer	1
12	17L927	PLUG, 3/4-16 UNF	1

* Keep these parts on hand to reduce downtime.

Accessories

Adapter 105276: Adapts bowl to accept drain valves listed below.
 3000 psi (210 bar) Maximum Working Pressure 3/4-16 Unf thread x 1/4 NPT

Drain Valves:
 210657 - 1/4 NPT(MBE) fluoroelastomer seals
 214037 - 1/4 NPT(MBE) PTFE seals
 5000 psi (350 bar) Maximum Working Pressure

FIG. 5

Instructions

The reference letters used in the following instructions refer to FIG. 5, page 8.



Follow **Pressure Relief Procedure**, page 5 before servicing or replacing any component.

Indicator (1)

The indicator provides a gradual warning of a dirty element.

Replace the indicator assembly (1) if the indicator is not working correctly. It is either always red or never red.

Fluoroelastomer O-Ring (6) and O-Ring Backup (7)

The o-rings seal the bowl (10) to the housing (3). If material leaks around the bowl, replace the o-ring (6) and o-ring backup (7).

1. Unscrew the bowl (10) and remove from the housing (3).
2. Remove the o-rings (6, 7).
3. Clean parts in a compatible solvent. Be careful not to damage the o-rings (6, 7) or sealing surfaces of the bowl (10) and housing (3).
4. Lubricate parts with No. 2 grease.
5. Reassemble parts as shown in FIG. 5, page 8. Be sure backup o-ring (7) is assembled with the groove facing upward, and the bowl (10) is tightened securely in the housing (3).

Bowl (10), Element (8) and Spring (9)

Clean the element when the indicator shows 3/4 red. If it is not cleaned promptly, the filter bypass valve opens and fluid is not filtered.

To reduce downtime, keep a spare bowl (10), element (8), and spring (9) on hand.

1. Before removing the bowl (10), direct the fluid through the bypass pipes or shut down the system.
2. Unscrew bowl (10), element (8) and remove from the housing.
3. Remove the spring (9) from the housing (3).
4. Install the spare spring (9).
5. Install the spare element (8) with the dome end up.
6. Lubricate the threads of the spare bowl (10) with No. 2 grease before screwing it into the housing (3). Tighten securely.
7. Clean the bowl (10) and the spring (9), removed in Steps 2 and 3, with compatible solvent. Do not use a wire brush or sharp object to clean. Store parts until needed.
8. Clean the element (8) with a small, soft brush like a paint brush. Blow out lodged particles with air. Inspect the element for damage. Discard the element if it is ruptured, damaged, or too dirty to clean.

Technical Specifications

Red Alert Filter		
	US	Metric
Maximum working pressure	3000 psi	21 MPa, 210 bar
Flow capacity	2 gpm	7.57 lpm
Filter		
Filter area	36 in. ²	232 cm ²
Filtration	380 micron	
Weight		
Weight	14 lbs 8 oz.	6.6 kg
Materials of Construction		
Wetted parts	iron, steel, fluoroelastomer, stainless steel	
Dimensions		
Width	4.5 in.	114 mm
Depth	4.62 in.	117 mm
Height	11.3 in.	287 mm

Dimensions and Mounting Pattern

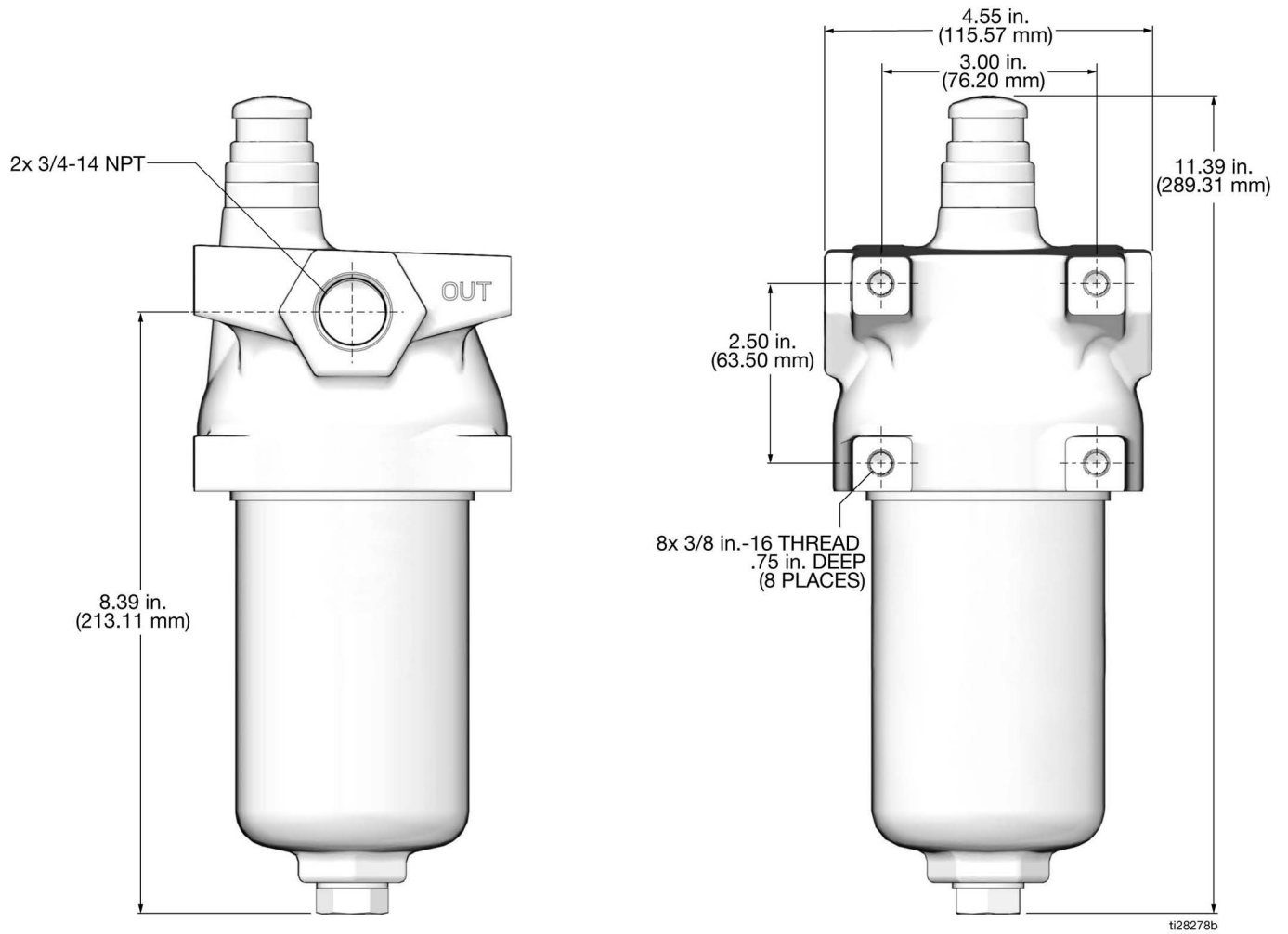

Graco Standard Warranty

Graco warrants all equipment referenced in this document which is manufactured by Graco and bearing its name to be free from defects in material and workmanship on the date of sale to the original purchaser for use. With the exception of any special, extended, or limited warranty published by Graco, Graco will, for a period of twelve months from the date of sale, repair or replace any part of the equipment determined by Graco to be defective. This warranty applies only when the equipment is installed, operated and maintained in accordance with Graco's written recommendations.

This warranty does not cover, and Graco shall not be liable for general wear and tear, or any malfunction, damage or wear caused by faulty installation, misapplication, abrasion, corrosion, inadequate or improper maintenance, negligence, accident, tampering, or substitution of non-Graco component parts. Nor shall Graco be liable for malfunction, damage or wear caused by the incompatibility of Graco equipment with structures, accessories, equipment or materials not supplied by Graco, or the improper design, manufacture, installation, operation or maintenance of structures, accessories, equipment or materials not supplied by Graco.

This warranty is conditioned upon the prepaid return of the equipment claimed to be defective to an authorized Graco distributor for verification of the claimed defect. If the claimed defect is verified, Graco will repair or replace free of charge any defective parts. The equipment will be returned to the original purchaser transportation prepaid. If inspection of the equipment does not disclose any defect in material or workmanship, repairs will be made at a reasonable charge, which charges may include the costs of parts, labor, and transportation.

THIS WARRANTY IS EXCLUSIVE, AND IS IN LIEU OF ANY OTHER WARRANTIES, EXPRESS OR IMPLIED, INCLUDING BUT NOT LIMITED TO WARRANTY OF MERCHANTABILITY OR WARRANTY OF FITNESS FOR A PARTICULAR PURPOSE.

Graco's sole obligation and buyer's sole remedy for any breach of warranty shall be as set forth above. The buyer agrees that no other remedy (including, but not limited to, incidental or consequential damages for lost profits, lost sales, injury to person or property, or any other incidental or consequential loss) shall be available. Any action for breach of warranty must be brought within two (2) years of the date of sale.

GRACO MAKES NO WARRANTY, AND DISCLAIMS ALL IMPLIED WARRANTIES OF MERCHANTABILITY AND FITNESS FOR A PARTICULAR PURPOSE, IN CONNECTION WITH ACCESSORIES, EQUIPMENT, MATERIALS OR COMPONENTS SOLD BUT NOT MANUFACTURED BY GRACO. These items sold, but not manufactured by Graco (such as electric motors, switches, hose, etc.), are subject to the warranty, if any, of their manufacturer. Graco will provide purchaser with reasonable assistance in making any claim for breach of these warranties.

In no event will Graco be liable for indirect, incidental, special or consequential damages resulting from Graco supplying equipment hereunder, or the furnishing, performance, or use of any products or other goods sold hereto, whether due to a breach of contract, breach of warranty, the negligence of Graco, or otherwise.

FOR GRACO CANADA CUSTOMERS

The Parties acknowledge that they have required that the present document, as well as all documents, notices and legal proceedings entered into, given or instituted pursuant hereto or relating directly or indirectly hereto, be drawn up in English. Les parties reconnaissent avoir convenu que la rédaction du présente document sera en Anglais, ainsi que tous documents, avis et procédures judiciaires exécutés, donnés ou intentés, à la suite de ou en rapport, directement ou indirectement, avec les procédures concernées.

Graco Information

For the latest information about Graco products, visit www.graco.com.

For patent information, see www.graco.com/patents.

TO PLACE AN ORDER, contact your Graco distributor or call to identify the nearest distributor.

Phone: 612-623-6928 **or Toll Free:** 1-800-533-9655, **Fax:** 612-378-3590

All written and visual data contained in this document reflects the latest product information available at the time of publication. Graco reserves the right to make changes at any time without notice.

Original instructions. This manual contains English. MM3A3940

Graco Headquarters: Minneapolis

International Offices: Belgium, China, Japan, Korea

GRACO INC. AND SUBSIDIARIES • P.O. BOX 1441 • MINNEAPOLIS MN 55440-1441 • USA
Copyright 2016, Graco Inc. All Graco manufacturing locations are registered to ISO 9001.

www.graco.com

Revision B, November 2023